

## JUMPER SLEEVE CX-JS



### Futures and benefits

The CX-JS jumper sleeve creates a built-in tool for easy, hand tightened, reliable connections. This innovative jumper sleeve allows the proper amount of hand tightened torque with out damaging connections.

Once the CX-JS is installed onto a jumper, the clear design provides visibility to the connector.

- ✓ Flexible, oval design provides superior tool-less torque.
- ✓ No over tightening
- ✓ Allows clear view of connector
- ✓ Easy to install
- ✓ PCT-made connectors, coaxial cable and jumpers
- ✓ Recommended for use with products able to tolerate 5-10 in lbs of torque

### Ordering Information

- CX-JS Jumper Sleeve

### Specifications

Parameters	Unit	CONEX-JS
Material	--	ABS
Operating Temperature Range	C / F	-40 to +60° / -40 to +140°
Used with Connector Types	mm / in	28.4 x 18 mm / 0.093 x 0.059
Weight	g / oz	1.865 / 0.066



CX-JS  
Jumper Sleeve



CX-JS  
(shown installed onto CONEX jumper)

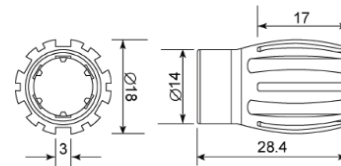

CX-JS  
Dimensions (mm)

