

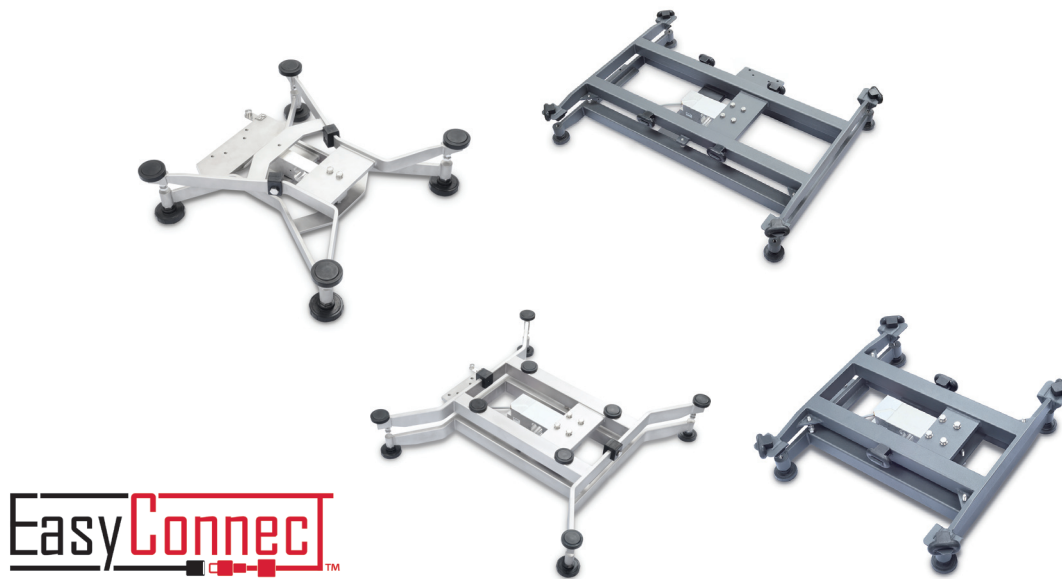

DEFENDER[®] 5000

Bases



Durable Bases for the Most Demanding of Industrial Applications

The OHAUS next generation Defender 5000 R and W Series bases offer two levels of durability for the most demanding of industrial applications. Both bases offer moisture-protected single-point load cells, steel construction, non-slip rubber adjustable feet, removable stainless steel weighing pans, and integrated leveling bubbles. Maximum non-approved resolution of 1:15,000d meets the needs of industrial weighing applications that require extreme accuracy.

Standard Features:

- **Durably Constructed To Withstand Harsh Industrial Environments**
The R Series features a stainless steel platform, powder-painted steel frame and an aluminum load cell. The W series features a stainless steel platform, frame, and aluminum loadcell.
- **Install Easily with the EasyConnect™ Feature**
The Defender 5000 bases are equipped with an EasyConnect cable, which allows instant configuration with Defender 5000 (TD52) indicators, speeding up installation.
- **Backed by Global Approvals for Legal-for-Trade Applications**
Defender 5000 bases carry OIML and EC Type approvals, which make them ideal for legal-for-trade use.

Ingeniously Practical

DEFENDER® 5000 Bases

Specifications

Model	D6RQDR	D15RQDR	D15RTDR	D30RTDR	D60RTDR	D15RQDL
Capacity × Default Readability	3/6 kg × 0.2/0.5 g	6/15 kg × 0.5/1 g		15/30 kg × 1/2 g	30/60 kg × 2/5 g	6/15 kg × 0.5/1 g
Safe Overload Capacity	150% of capacity					
Base Construction	Stainless steel removable weighing platform, powder-coated steel base construction					
Linearity/Repeatability	± 2d					
Load Cell Capacity	11 kg	22 kg		50 kg	100 kg	22 kg
Load Cell Cable	1.5 m L × 6-wire			2 m L × 6-wire		
Load Cell Type	350 Ohm, aluminum, single point					
Load Cell Excitation	5-15V DC/AC					
Load Cell Rated Output	2mV/V					
Load Cell Protection	IP67					
Base Dimensions (B × A × C × D × E)	305 × 305 × 99 × 60 × 388 mm		355 × 305 × 99 × 60 × 388 mm			400 × 400 × 120 × 70 × 428 mm
Shipping Dimensions (L × W × H)	480 × 445 × 363 mm					800 × 600 × 235 mm
Net Weight	6.5 kg		7.5 kg		8.6 kg	
Shipping Weight	8 kg		9 kg		10 kg	

Model	D30RQDL	D60RQDL	D60RTDL	D150RTDL	D60RQDX	D150RQDX
Capacity × Default Readability	15/30 kg × 1/2 g	30/60 kg × 2/5 g		60/150 kg × 5/10 g	30/60 kg × 2/5 g	60/150 kg × 5/10 g
Safe Overload Capacity	150% of capacity					
Base Construction	Stainless steel removable weighing platform, powder-coated steel base construction					
Linearity/Repeatability	± 2d					
Load Cell Capacity	50 kg	100 kg		250 kg	100 kg	250 kg
Load Cell Cable	2 m L × 6-wire					
Load Cell Type	350 Ohm, aluminum, single point					
Load Cell Excitation	5-15V DC/AC					
Load Cell Rated Output	2mV/V					
Load Cell Protection	IP67					
Base Dimensions (B × A × C × D × E)	400 × 400 × 120 × 70 × 428 mm		500 × 400 × 110 × 80 × 523 mm		500 × 500 × 120 × 80 × 523 mm	
Shipping Dimensions (L × W × H)	800 × 600 × 235 mm		994 × 680 × 235 mm			
Net Weight	8.6 kg		17 kg		19 kg	
Shipping Weight	10 kg		20 kg		21 kg	

Model	D60RQDV	D150RQDV	D300RQDV	D150RTDV	D300RTDV	D600RTDV
Capacity × Default Readability	30/60 kg × 2/5 g	60/150 kg × 5/10 g	150/300 kg × 10/20 g	60/150 kg × 5/10 g	150/300 kg × 10/20 g	300/600 kg × 20/50 g
Safe Overload Capacity	150% of capacity					
Base Construction	Stainless steel removable weighing platform, powder-coated steel base construction					
Linearity/Repeatability	± 2d					
Load Cell Capacity	100 kg	250 kg	500 kg	250 kg	500 kg	750 kg
Load Cell Cable	2 m L × 6-wire					
Load Cell Type	350 Ohm, aluminum, single point					
Load Cell Excitation	5-15V DC/AC					
Load Cell Rated Output	2mV/V					
Load Cell Protection	IP67					
Base Dimensions (B × A × C × D × E)	610 × 610 × 130 × 90 × 633 mm			800 × 600 × 132 × 90 × 821 mm		
Shipping Dimensions (L × W × H)	1165 × 780 × 235 mm					
Net Weight	31 kg			39 kg		
Shipping Weight	34 kg			42 kg		

DEFENDER[®] 5000 Bases

Specifications

Model	D6WQDR	D15WQDR	D15WQDL	D30WQDL	D60WQDL
Capacity × Default Readability	3/6 kg × 0.2/0.5 g	6/15 kg × 0.5/1 g		15/30 kg × 1/2 g	30/60 kg × 2/5 g
Safe Overload Capacity	150% of capacity				
Base Construction	Stainless steel removable weighing platform with stainless steel frame				
Linearity/Repeatability	± 2d				
Load Cell Capacity	11 kg	22 kg		50 kg	100 kg
Load Cell Cable	1.5 m L × 6-wire			2 m L × 6-wire	
Load Cell Type	350 Ohm, aluminum, single point				
Load Cell Excitation	5-15V DC/AC				
Load Cell Rated Output	2mV/V				
Load Cell Protection	IP67				
Base Dimensions (B × A × C × D × E)	305 × 305 × 99 × 60 × 328 mm			400 × 400 × 120 × 70 × 423 mm	
Shipping Dimensions (L × W × H)	480 × 445 × 363 mm			800 × 600 × 235 mm	
Net Weight	6 kg			8.6 kg	
Shipping Weight	8.5 kg			10 kg	

Model	D60WTDL	D150WTDL	D60WQDX	D150WQDX	D60WQDV
Capacity × Default Readability	30/60 kg × 2/5 g	60/150 kg × 5/10 g	30/60 kg × 2/5 g	60/150 kg × 5/10 g	30/60 kg × 2/5 g
Safe Overload Capacity	150% of capacity				
Base Construction	Stainless steel removable weighing platform with stainless steel frame				
Linearity/Repeatability	± 2d				
Load Cell Capacity	100 kg	250 kg	100 kg	250 kg	100 kg
Load Cell Cable	2 m L × 6-wire				
Load Cell Type	350 Ohm, aluminum, single point				
Load Cell Excitation	5-15V DC/AC				
Load Cell Rated Output	2mV/V				
Load Cell Protection	IP67				
Base Dimensions (B × A × C × D × E)	500 × 400 × 110 × 80 × 523 mm		500 × 500 × 120 × 80 × 523 mm		610 × 610 × 130 × 90 × 633 mm
Shipping Dimensions (L × W × H)	994 × 680 × 235 mm				1165 × 780 × 235 mm
Net Weight	17 kg				31 kg
Shipping Weight	19 kg				34 kg

Model	D150WQDV	D300WQDV	D150WTDV	D300WTDV	D600WTDV
Capacity × Default Readability	60/150 kg × 5/10 g	150/300 kg × 10/20 g	60/150 kg × 5/10 g	150/300 kg × 10/20 g	300/600 kg × 20/50 g
Safe Overload Capacity	150% of capacity				
Base Construction	Stainless steel removable weighing platform with stainless steel frame				
Linearity/Repeatability	± 2d				
Load Cell Capacity	250 kg	500 kg	250 kg	500 kg	750 kg
Load Cell Cable	2 m L × 6-wire	1.5 m L × 6-wire		2 m L × 6-wire	
Load Cell Type	350 Ohm, aluminum, single point				
Load Cell Excitation	5-15V DC/AC				
Load Cell Rated Output	2mV/V				
Load Cell Protection	IP67				
Base Dimensions (B × A × C × D × E)	610 × 610 × 130 × 90 × 633 mm		800 × 600 × 132 × 90 × 822 mm		
Shipping Dimensions (L × W × H)	1165 × 780 × 235 mm				
Net Weight	31 kg		39 kg		
Shipping Weight	34 kg		42 kg		

DEFENDER[®] 5000 Bases

Dimensions

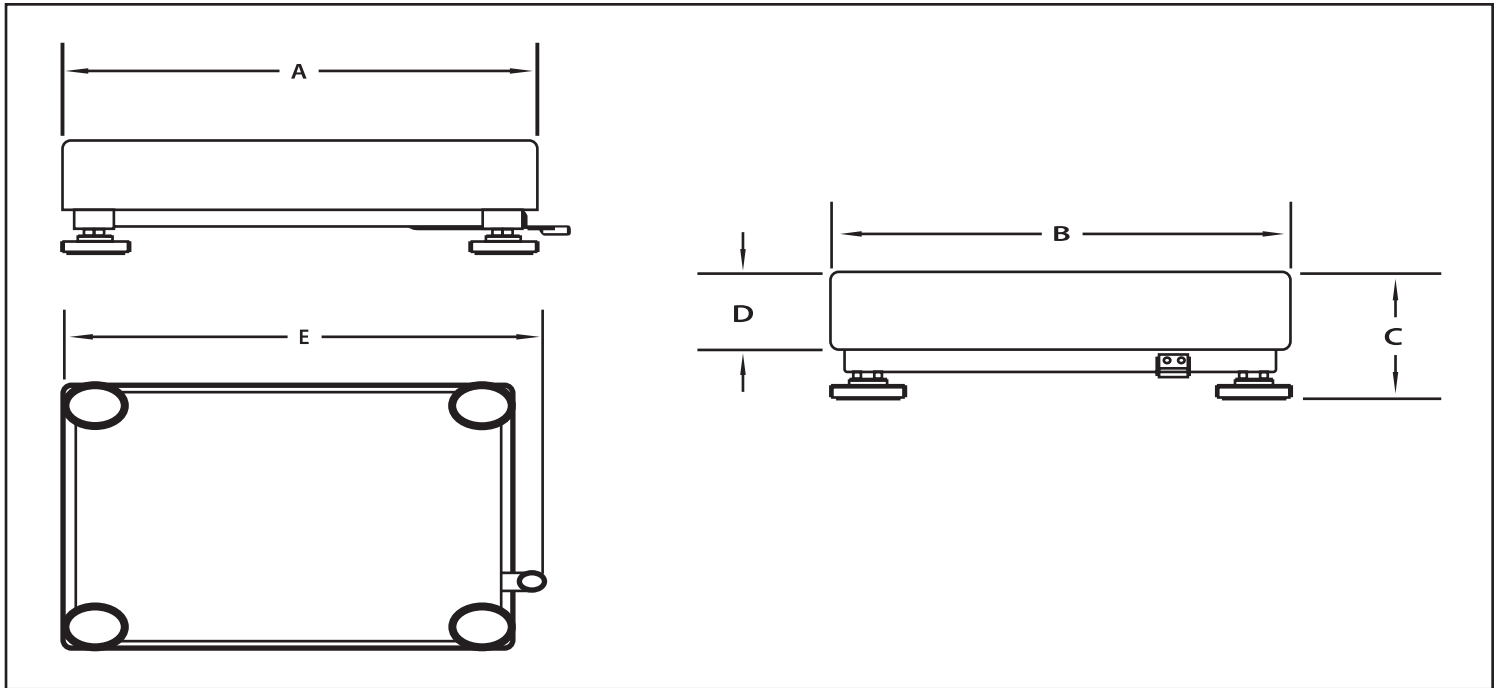

Compliance

- **Metrology:** Metrology: OIML (Load Cells: Certificates R60/2000-NL1-12-41, R60/2000-NL1-12-42, R60/2000-NL1-12-43, R60/2000-NL1-14.24)
- **Compliance Marks:** CE

Construction

R Series Base: 304-grade stainless steel platform, sand grey powder coated steel frame, aluminum load cell, level indicator

W Series Base: 304-grade stainless steel platform, stainless steel frame, IP67 load cell, stainless steel level indicator

Accessories

Column Kit, 35 cm, CS, D52	30424410
Column Kit, 68 cm, CS, D52	30424411
Column Kit, 98 cm, CS, D52	30424412
Column Kit, 35 cm, SST, D52	30424413
Column Kit, 68 cm, SST, D52	30424414
Column Kit, 98 cm, SST, D52	30424415
Front Mount Kit, D52	30424024
Print Holder Kit, D52	30424025
LC Extension Cable, 9 meters, D52 ¹	30424409
Load Cell Cable Adapter Kit, to D52 Base	30429931
Wheel Kit, Defender Series (for bases up to 300 kg) ¹ ..	30372146
Wheel kit, SST, Defender Series ¹	30616409

¹ Cannot be used for legal-for-trade applications

**OHAUS Asia/Pacific
Headquarters**
6F, Block 7, 471 Guiping Road
Shanghai 200233
China

e-mail: ChinaSales@ohaus.com
Tel: +86 21 64855408

www.ohaus.com

The management system
governing the manufacture
of this product is
ISO 9001:2015 certified.

30385188

