

Stainless Steel Top Chain

TT

Straight Running

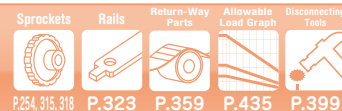

Features

1. International standard shape.
2. All parts are made of stainless steel.
3. All edges of the top plates are smoothly chamfered, ensuring smooth transfer.

Chain Material

The following types are available for stainless steel top chains.

- ◆N series: Top plate is made of martensitic stainless steel.
- ◆SS series: Made of type 304 stainless steel or equivalent.
Highly resistant to corrosion and is clean and sanitary.

Note: Contact a Tsubaki representative if the chain will be used in extreme environments.

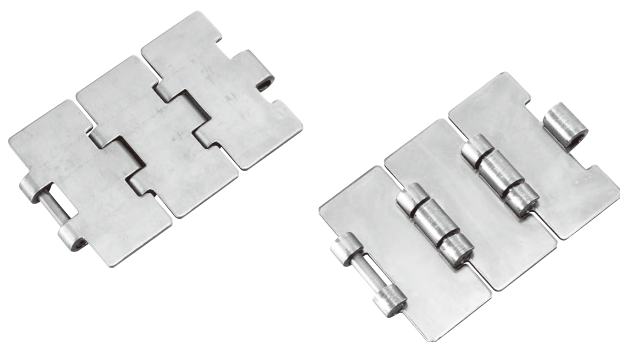

Chain pitch mm	Backflex radius mm	Number of links per unit
38.10	180	80

Drawing

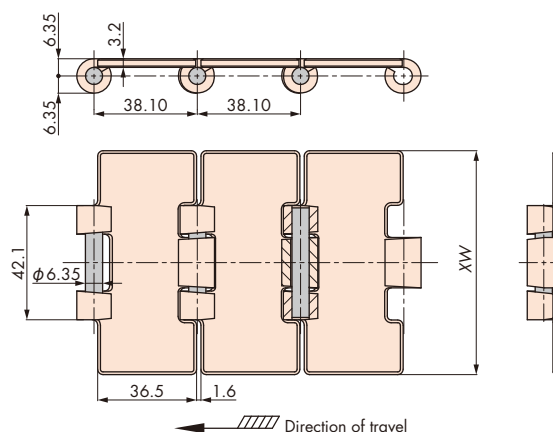

Tsubaki Model Table

Material	N	SS	Chain width XW	Chain mass kg/m
Max. allowable load kN {kgf}	2.16{220}			
Chain type	TT635-N	TT635-SS	63.5	2.3
	TT762-N	TT762-SS	76.2	2.5
	TT826-N	TT826-SS	82.6	2.6
	TT1016-N	TT1016-SS	101.6	3.0
	TT1143-N	TT1143-SS	114.3	3.3
	TT1270-N	TT1270-SS	127.0	3.8
	TT1524-N	TT1524-SS	152.4	4.2
	TT1905-N	TT1905-SS	190.5	5.1

Note: 1. Standard products.

2. As of October 2010, the standard product lineup was expanded.

3. The top surface of the plates are polished.

4. No additional machining or processing should be performed on N series top plate. Cracking or fracturing may occur during bending process.

Model Numbering

◆Chain

Chain type	Chain width	Base chain material mark	Number of links
TT	826 <small>Note: 2</small>	N <small>Note: 3</small>	20L <small>Note: 4</small>

◆Connecting pin

Chain type	Base chain material mark	Connecting pin
TT	N <small>Note: 3</small>	RP

Note: 1. Do not leave space between letters and symbols.

2. Please check the widths of chains in the above Tsubaki model table.

3. Please check the materials of base chains in the above Tsubaki model table.

4. Minimum quantity: 2, maximum quantity: 99999.