

Structure

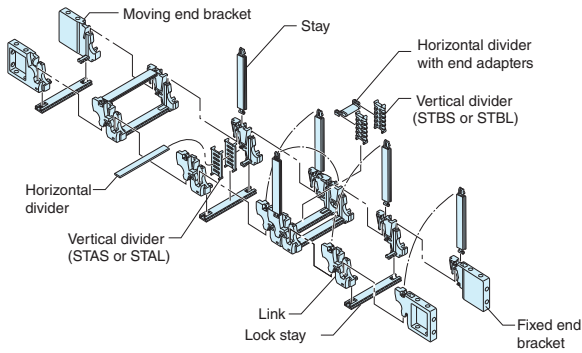

Cross-section dimensions

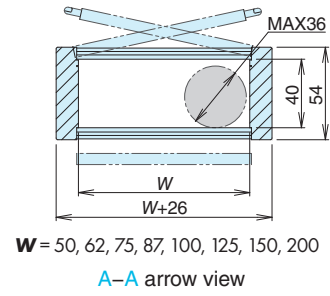

Divider dimensions

(1) When using only vertical dividers

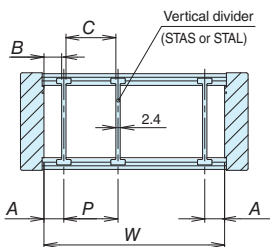

(2) Fully-stayed multiple height separation (DSA type)

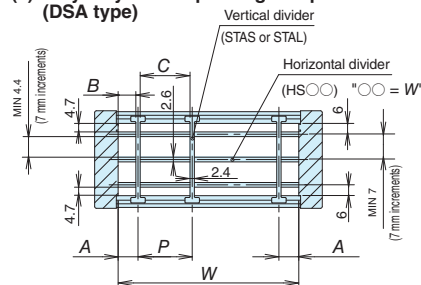

(3) Partial multiple height separation (DSB type)

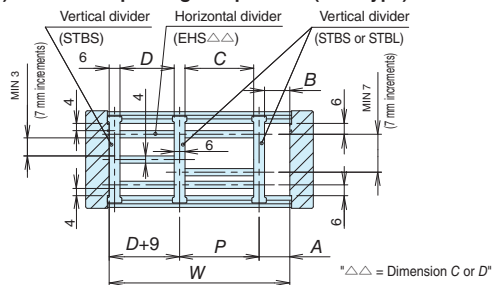

Vertical divider (fastening method)	Inner width W (mm)	A (mm)	B (mm)	P (mm)	C (mm)	D (mm)
STAS (sliding installation)	Common for all widths	3 to 6.5	1.8 to 63.8	8 to 140	5.6 to 137.6	
STAL (fixable installation)	50	5 to 37	3.8 to 35.8	8 to 40	5.6 to 37.6	4 mm increments
	62	7 to 47	5.8 to 45.8	8 to 48	5.6 to 45.6	
	75	5.5 to 61.5	4.3 to 60.8	8 to 64	5.6 to 61.6	
	87	3.5 to 63.5	2.3 to 62.3	8 to 80	5.6 to 77.6	
	100	6 to 62	4.8 to 60.8	8 to 88	5.6 to 85.6	
STBS (sliding installation)	Common for all widths	min 3	min 0	26 to (W-6)	20 to (W-12)	20 to (W-12)
	50	min 5	min 2	-	-	20 to 36
	62	min 7	min 4	-	-	20 to 46
	75	min 5.5	min 2.5	28 to 40	22 to 34	20.5 to 60.5
	87	min 3.5	min 0.5	28 to 52	22 to 46	22.5 to 74.5
STBL (fixable installation)	Common for all widths	min 3	min 3	28 to 64	22 to 58	21 to 85
	50	min 5	min 2	28 to 88	22 to 82	21.5 to 109.5
	62	min 7	min 4	28 to 111	22 to 106	22 to 134
	75	min 5.5	min 2.5	28 to 164	22 to 138	23 to 187
	87	min 3.5	min 0.5	-	-	-

Notes:

- A: Distance from center of vertical divider to end face of link
- B: Gap between vertical divider and link
- P: Distance between the centers of neighboring vertical dividers
- C: Gap between neighboring vertical dividers
- D: Gap between neighboring vertical dividers when vertical dividers/dividers for both ends are installed

Note: Make the gap between cables/hoses and the divider or link (d in the figure below) to whichever of the following two values is larger: 2 mm or greater or the outer diameter of the cable or hose x 0.1.

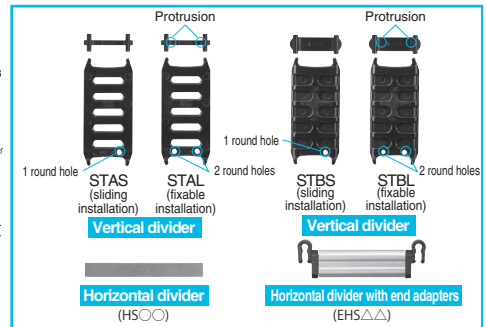
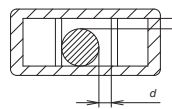

Note: The maximum values for A, B, P, and C are applied when using horizontal dividers.

Dimensions & brackets

W (mm)	a (mm)	b (mm)	c (mm)	Strain relief comb n _z (toothed)
50	64	76	33	3
62	76	88	-	-
75	89	101	58	5
87	101	113	-	-
100	114	126	83	7
125	139	151	108	9
150	164	176	133	11
200	214	226	-	-

Bending radius R (mm)	Mounting height H' (mm)
75	238 to 258
100	288 to 308
125	338 to 358
150	388 to 408

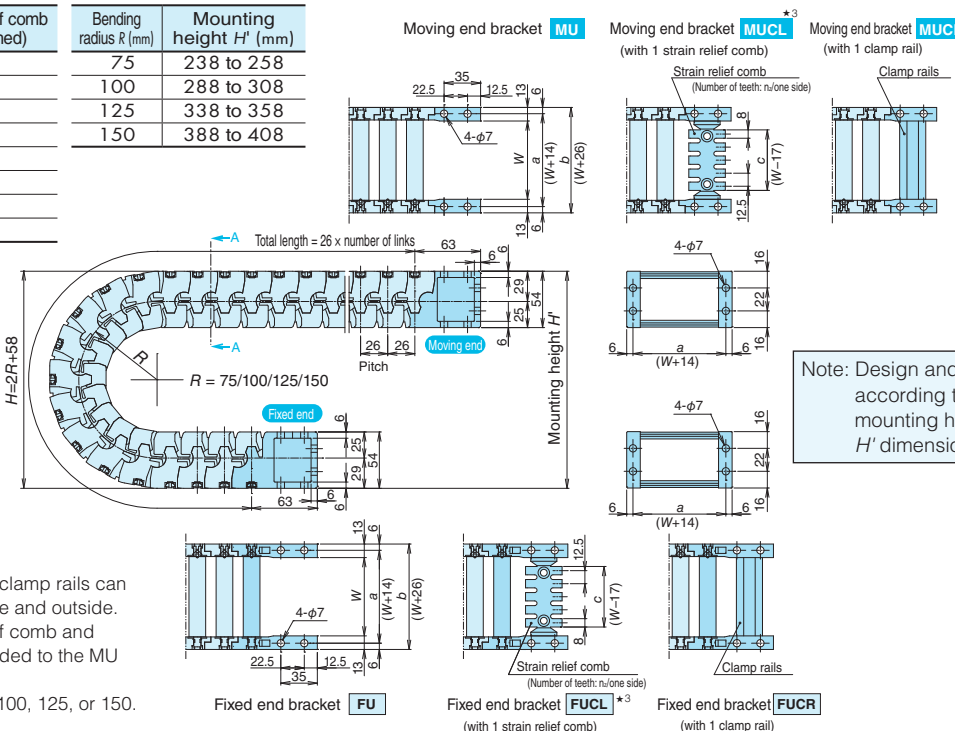

Note: Design and install according to the mounting height H' dimension.

- Notes:
- Strain relief combs and clamp rails can be installed on the inside and outside.
 - Note that the strain relief comb and clamp rail cannot be added to the MU and FU brackets.
- ★3. Only when W = 50, 75, 100, 125, or 150.