

# Model Numbers and Specifications

## Stainless Steel (KE-SS) Models

### Notes

1. The main unit is made of highly anticorrosive austenite stainless steel.
2. Locking bolts are lubricated so that no additional lubrication is necessary during assembly.

### Applications

Most suitable for clean-room operation requiring minimum rust.

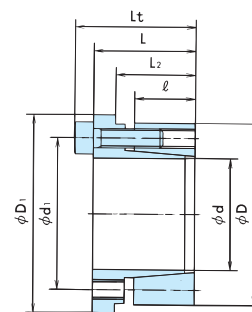

\* Note) 3

Model No. d X D Shaft Diameter X Outer Diameter mm	Dimensions mm						Transmissible Torque		Transmissible Thrust		Contact Pressure				Locking Bolts				Mass kg
	ℓ	L2	L	Lt	d1	D1	Mt		Pax		Shaft P		Hub P'		Quantity	Size	Tightening Torque MA		
							N · m	{kgf · m}	kN	{kgf}	MPa	{kgf/mm²}	MPa	{kgf/mm²}			N · m	{kgf · m}	
PL005 X 016 KE-SS	8	12	13.5	16.5	11.5	18.5	5.0	0.51	1.89	193	111	11.3	35	3.5	3	M 3 × 10	0.9	0.092	0.02
PL006 X 017 KE-SS	8	12	13.5	16.5	12.5	19.5	6.0	0.61	1.89	193	92	9.4	33	3.3	3	M 3 × 10	0.9	0.092	0.02
PL008 X 021 KE-SS	10	14.5	16.5	20.5	15.6	23.5	14.2	1.5	3.37	344	98	10.1	38	3.8	3	M 4 × 14	2.2	0.22	0.03
PL010 X 023 KE-SS	10	14.5	16.5	20.5	17.6	25.5	17.7	1.8	3.37	344	79	8.0	34	3.5	3	M 4 × 14	2.2	0.22	0.04
PL011 X 024 KE-SS	10	14.5	16.5	20.5	18.6	26.5	19.6	2.0	3.37	344	72	7.3	33	3.4	3	M 4 × 14	2.2	0.22	0.04
PL012 X 026 KE-SS	10	14.5	16.5	20.5	20	28.5	28.4	2.9	4.49	458	88	8.9	40	4.1	4	M 4 × 14	2.2	0.22	0.05
PL014 X 028 KE-SS	12	17.5	20	24	22	30.5	41.6	4.2	5.61	573	78	8.0	39	4.0	5	M 4 × 14	2.2	0.22	0.06
PL015 X 029 KE-SS	12	17.5	20	24	23	31.5	44.5	4.5	5.61	573	73	7.4	38	3.9	5	M 4 × 14	2.2	0.22	0.07
PL016 X 030 KE-SS	12	17.5	20	24	24	32.5	47.4	4.8	5.61	573	68	7.0	36	3.7	5	M 4 × 14	2.2	0.22	0.07
PL017 X 031 KE-SS	12	17.5	20	24	25	33.5	60.6	6.2	6.73	687	77	7.9	42	4.3	6	M 4 × 14	2.2	0.22	0.07
PL018 X 032 KE-SS	12	17.5	20	24	26	34.5	64.1	6.5	6.73	687	73	7.4	41	4.2	6	M 4 × 14	2.2	0.22	0.08
PL019 X 033 KE-SS	12	17.5	20	24	27	35.5	67.7	6.9	6.73	687	69	7.1	40	4.1	6	M 4 × 14	2.2	0.22	0.08
PL020 X 038 KE-SS	15	20.5	25	30	30	42	141	14.4	13.4	1363	104	10.6	55	5.6	6	M 5 × 20	5.3	0.54	0.14
PL022 X 040 KE-SS	15	20.5	25	30	32	44	156	15.9	13.4	1363	95	9.7	52	5.3	6	M 5 × 20	5.3	0.54	0.15
PL024 X 042 KE-SS	15	20.5	25	30	34	46	170	17.3	13.4	1363	87	8.9	50	5.1	6	M 5 × 20	5.3	0.54	0.16
PL025 X 043 KE-SS	15	20.5	25	30	35	47	177	18.0	13.4	1363	83	8.5	48	4.9	6	M 5 × 20	5.3	0.54	0.17
PL028 X 046 KE-SS	17	22.5	28	33	38.5	50	264	26.9	17.8	1818	88	8.9	53	5.4	8	M 5 × 20	5.3	0.54	0.21
PL030 X 048 KE-SS	17	22.5	28	33	40.5	52	283	28.9	17.8	1818	82	8.3	51	5.2	8	M 5 × 20	5.3	0.54	0.22
PL032 X 050 KE-SS	17	22.5	28	33	42.5	54	302	30.8	17.8	1818	77	7.8	49	5.0	8	M 5 × 20	5.3	0.54	0.23
PL035 X 057 KE-SS	19	25	32	38	47.5	62	351	35.8	18.9	1932	67	6.8	41	4.2	6	M 6 × 25	9.0	0.92	0.36
PL038 X 060 KE-SS	19	25	32	38	50.5	65	508	51.8	25.2	2577	82	8.4	52	5.3	8	M 6 × 25	9.0	0.92	0.39
PL040 X 062 KE-SS	19	25	32	38	52.5	67	535	54.6	25.2	2577	78	7.9	50	5.1	8	M 6 × 25	9.0	0.92	0.40
PL042 X 064 KE-SS	19	25	32	38	54.5	69	561	57.3	25.2	2577	74	7.6	49	5.0	8	M 6 × 25	9.0	0.92	0.42
PL045 X 067 KE-SS	19	25	32	38	57.5	72	602	61.4	25.2	2577	69	7.1	46	4.7	8	M 6 × 25	9.0	0.92	0.44
PL048 X 070 KE-SS	19	25	32	38	60.5	75	722	73.7	28.4	2899	73	7.4	50	5.1	9	M 6 × 25	9.0	0.92	0.46
PL050 X 072 KE-SS	19	26	34.5	40.5	63.5	77	836	85.3	31.6	3221	78	7.9	54	5.5	10	M 6 × 25	9.0	0.92	0.50

Notes) 1. All models are in stock.

2. Mt indicates torque at 0 transmissible thrust, while Pax indicates transmissible thrust at 0 torque. If transmissible torque and thrust apply simultaneously calculate and compare the combined value with the transmissible torque provided in the table.

3. Dimensions when this product is attached to the shaft and hub.