

Hollow Pin Chain

In Hollow Pin Chain, the pin is made with a hole, enabling various attachments to be installed simply and easily. This type of chain is used for general-purpose conveyance.

- Features:
1. Regardless of whether the chain is straight or wrapped around a sprocket, the center distance between attachments is always the same.
 2. The load from the attachments is distributed equally to both sides of the link plates. This provides advantages in terms of strength, and the chain has less tendency to wind while running.
 3. It is easy to replace attachments, do maintenance, or adjust attachment spacing even while the chain is installed on equipment.

Hollow Pin Double Pitch Chain

Base Chain

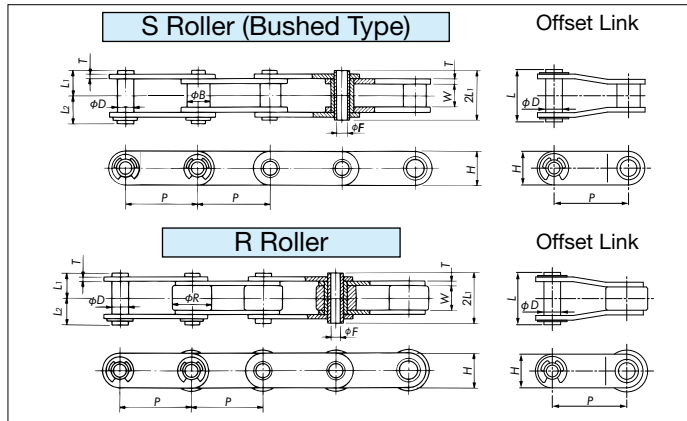

Maximum Allowable Load

kN {kgf}

Size	Series			
	HP	HPNP	LMCHP	HPSS
RF2040	1.77{180}		1.47{150}	0.44{ 45}
RF2050	3.14{320}		2.55{260}	0.69{ 70}
RF2060	4.22{430}		3.43{350}	1.03{105}
RF2080	7.65{780}		6.18{630}	1.77{180}

Base Chain Dimensions

Size	Roller Type	Pitch P	Bush Dia. B	Roller Dia. R	Width Between Inner Link Plates W	Plate		Pin				Offset Pin Length L	Approx. Mass kg/m		No. of Links per Unit
						Thickness T	Width H	Outer Dia. E	Inner Dia. F (min.)	L ₁	L ₂		Bushed Type	R Roller	
RF2040	S	25.40	7.92	15.88	7.95	1.5	12.0	5.68	4.00	8.00	9.50	19.1	0.46	0.82	120
RF2050		31.75	10.16	19.05	9.53	2.0	15.0	7.22	5.12	10.05	11.65	23.4	0.75	1.21	96
RF2060		38.10	11.91	22.23	12.70	2.4	17.2	8.38	5.99	12.55	14.25	28.7	1.38	2.06	80
RF2080		50.80	15.88	28.58	15.88	3.2	23.0	11.375	8.02	16.25	17.80	35.7	1.80	2.81	60

- Note:
1. S roller type (bushed type) chains have no rollers.
 2. HPSS chains are not pre-lubricated before shipping. Always lubricate the chain before use, except when using underwater or when the chain will contact water. Using a chain without lubrication may result in premature articulation problems. Maximum allowable loads are based on lubricated (including water lubricated) conditions.
 3. The above dimensions are nominal dimensions and may differ from actual dimensions.

Hollow Pin RS Chain

Base Chain

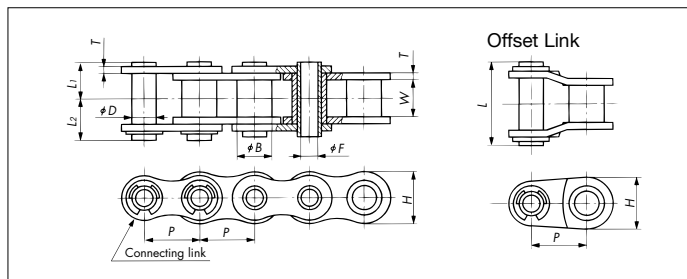

Maximum Allowable Load

kN {kgf}

Size	Series			
	HP	HPNP	LMCHP	HPSS
RS40	1.77{180}		1.47{150}	0.44{ 45}
RS50	3.14{320}		2.55{260}	0.69{ 70}
RS60	4.22{430}		3.43{350}	1.03{105}
RS80	7.65{780}		6.18{630}	1.77{180}

Base Chain Dimensions

Size	Pitch P	Bush Dia. B	Width Between Inner Link Plates W	Plate		Pin				Offset Pin Length L	Approx. Mass kg/m	No. of Links per Unit
				Thickness T	Width H	Outer Dia. E	Inner Dia. F (min.)	L ₁	L ₂			
RS40	12.70	7.92	7.95	1.5	12.0	5.68	4.00	8.00	9.50	19.1	0.53	240
RS50	15.875	10.16	9.53	2.0	15.0	7.22	5.12	10.05	11.65	23.4	0.86	192
RS60	19.05	11.91	12.70	2.4	18.1	8.38	5.99	12.55	14.25	28.7	1.27	160
RS80	25.40	15.88	15.88	3.2	24.1	11.375	8.02	16.25	17.80	35.7	2.15	120

- Note:
1. HPSS chains are not pre-lubricated before shipping. Always lubricate the chain before use, except when using underwater or when the chain will contact water. Using a chain without lubrication may result in premature articulation problems. Maximum allowable loads are based on lubricated (including water lubricated) conditions.
 2. The above dimensions are nominal dimensions and may differ from actual dimensions.