

# Type 600 Stainless Steel Ball Valves

## Reduced bore, Uni-body design, Threaded ends

### Features

- Blowout-proof stem
- Choice of threaded ends:
  - Rc threads to JIS B0203 (BS 21) (Fig. UTKM)
  - NPT threads to ASME B1.20.1 (Fig. AKUTKM)

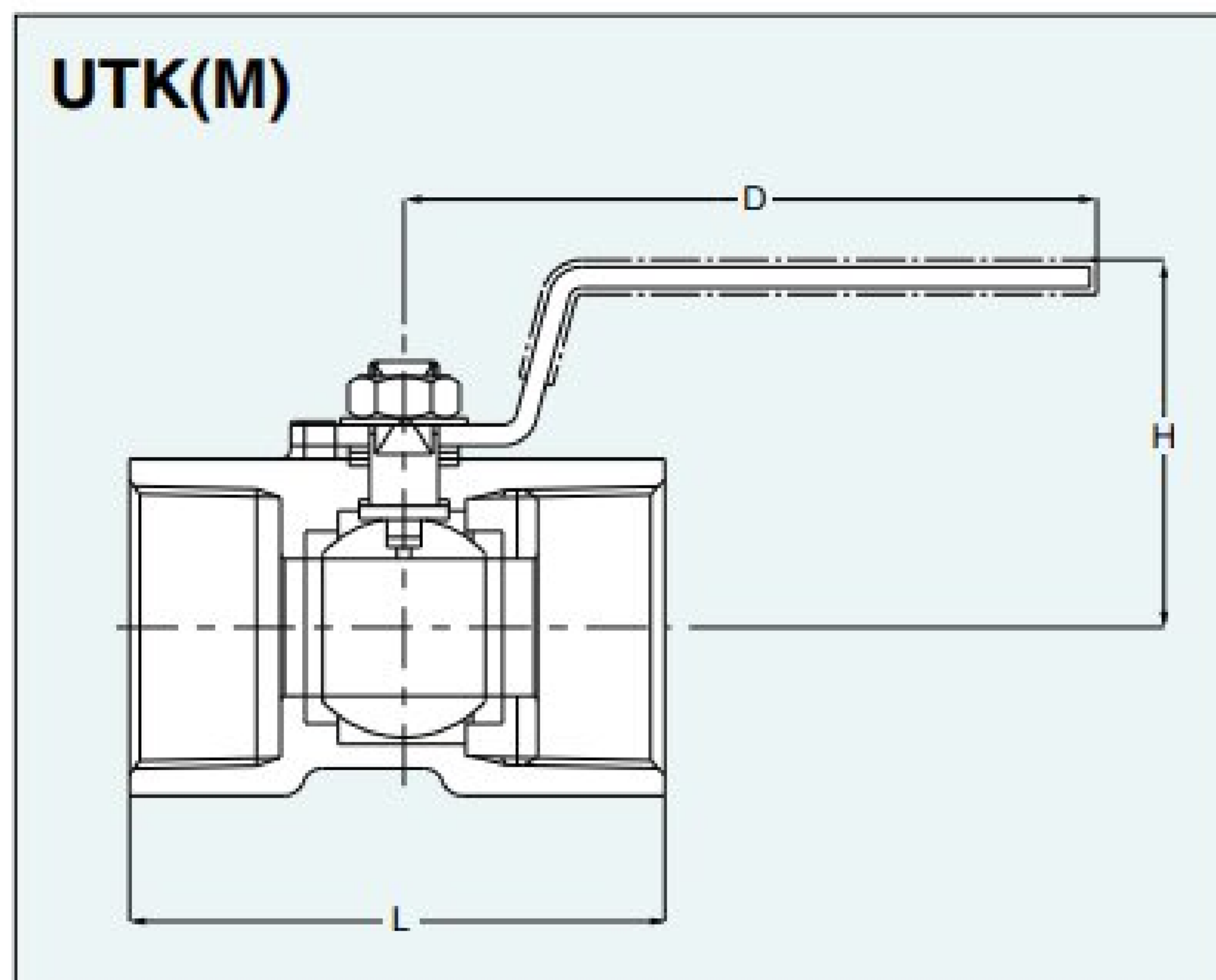

### Dimensions of UTK(M)

Nominal Size	NPS	1/4	3/8	1/2	3/4	1	1 1/4	1 1/2	2
	DN	8	10	15	20	25	32	40	50
Ball bore		4.5	6.8	9.2	12.5	16	20	24.5	32
L		39	44	56.5	59	71	78	83	100
H		31	36	41	44	48	54	65	72
D		60	70	85	85	100	100	125	125

Unit: mm

Page 102 for Pressure-Temperature Ratings.

### Materials

Parts	Materials
Body	A351 Gr.CF8 (A351 Gr.CF8M)
Ball	A276 Type 304 or A351 Gr.CF8 (A276 Type 316* or A351 Gr.CF8M*)
Stem	A276 Type 316 or 304
Seat	G/F PTFE
Gland packing	G/F PTFE
Handle	Plastic covered S.S.

End to end dimensions: KITZ standard  
 \* CF8M/316 are available for (M).

### Valve operator

Lever operation  
 T-type handle as option