

EXOWELD[®]

Exothermic Welding Materials

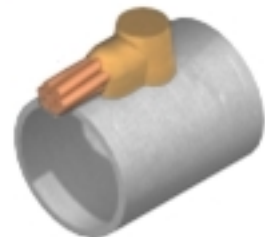
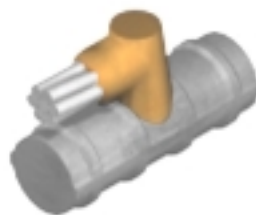
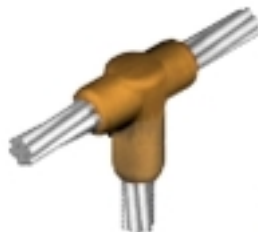
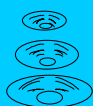
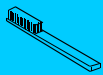
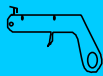
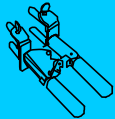
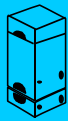

INTRODUCTION

What is EXOWELD ?

EXOWELD is the brand name of exothermic materials which are manufactured and sold by EXOTECH INC Korea.

EXOWELD Exothermic welding is a cost effective method of completing a high quality electrical connection. The process is simple to follow and through the use of a high temperature reaction a long lasting, quality electrical bond is created between conductors.

Making an EXOWELD Connection

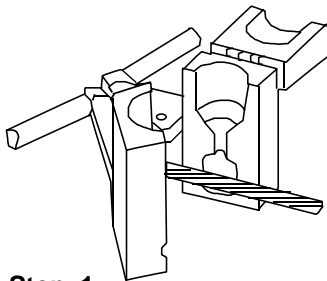

Step 1

Clean the conductors to be welded.
Place the cables into position in the mold.

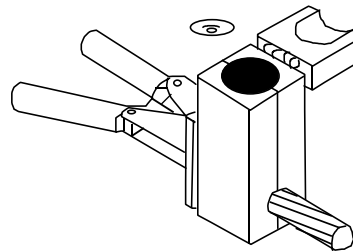

Step 2

Close the handle clamp to lock the mold.
Place the disk into position in the mold.

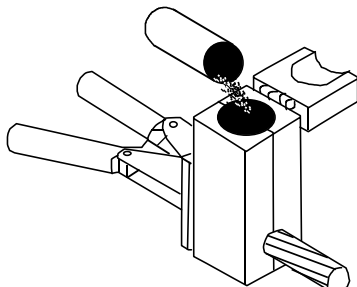

Step 3

Place the weld metal into the mold.
Sprinkle the starting powder over the
weld metal and on the lip of the mold.

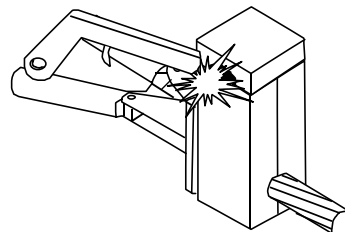

Step 4

Close the cover and ignite using flint ignitor.
Open the mold after the metal solidifies.
Remove the slag from the mold before
making the next connection.

Advantages

1. Does not deteriorate with age since the connections are permanent.
2. Does not loosen as the EXOWELD connections create a permanent molecular bond.
3. Excellent corrosion resistance.
4. Electrical characteristics are higher than typical mechanical connections.
5. Does not increase resistance above that of the conductor.
6. No external power or heat is required to make connections.
7. Quality can be assessed visually.
8. Easy and simple to install.

USEFUL INFORMATION

Exothermic welding process

The exothermic welding process is a method of making electrical connections of copper to copper or copper to steel in which no outside source of heat or power is required.

In this process, granular metals (granular copper oxide and aluminium) are placed from a container into a graphite crucible and ignited.

The reduction of copper oxide by the aluminium (exothermic reaction) produces molten copper and aluminium oxide slag.

The slag floats to the surface and the disk melts, allowing molten copper to flow into the weld cavity and complete the weld. The weld is allowed to solidify. The mold is removed and made ready for the next weld. The process takes seconds to complete.

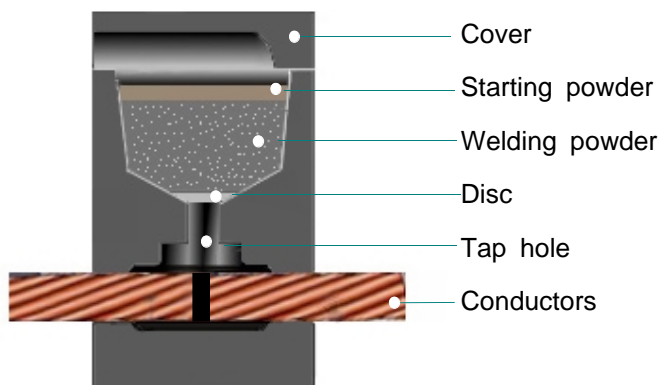

Standard size of Copper conductors

Cross Section (mmsq)	Diameter (mm)	Composition N / mm Φ
6	3.12	7/1.04
10	4.05	7/1.35
16	5.10	7/1.70
25	6.42 6.75	7/2.14 19/1.35
35	7.56 7.65	7/2.52 19/1.53
50	8.9	19/1.78
70	10.7	19/2.14
95	12.46 12.6	37/1.78 19/2.52
120	14.21	37/2.03
150	15.75	37/2.25
185	17.64	37/2.52
240	20.25	61/2.25
300	22.68	61/2.52
400	25.69 25.96	61/2.85 91/2.35
500	28.8 29.15	61/3.2 91/2.65

This brochure shows standard type of connections.

Use the index and check the type of connection required. If a suitable mold is not listed for your required application, contact EXOTECH for the availability of non standard type molds.

1. Check the type of connection.
2. Check the sizes of conductors to be welded.
3. Check tools and parts required for welding.

TOOLS AND ACCESSORIES

Exothermic weld metal is a mixture of copper oxide and aluminum, packaged by size in a plastic cartridge. The cartridge contains the starting powder at the bottom with the weld metal on top. These cartridges are packaged in boxes along with metal disks. Each weld requires one disk.



Molds

A graphite mold is used for exothermic welding connections. The mold controls the direction and speed of the molten weld metal flow and the formation of the weld.

The graphite used is a high temperature type that lasts for an average of 50 or more welding connections under normal usage.



Handle Clamps such as the one shown above are required for most molds. Two types of Handle Clamps are available.

1. EC-M for all molds 3" wide.
2. EC-L for all molds 4" wide.

For some molds, specialized frames with handles are required.

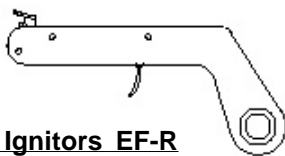

Flint Ignitors EF-R

Flint Ignitors are used to ignite the starting material.

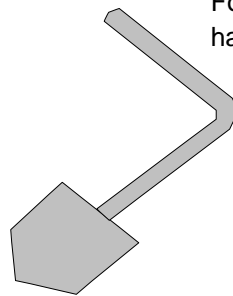

Slag Removal Spade ET-009

is useful for removing the slag from the mold after the welding connection is completed. They are especially useful for horizontally split molds.

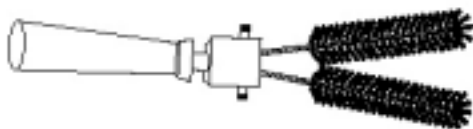

Cable Cleaning Brush ET-008-1,

V-Shaped Brush cleans any conductor and is especially useful for coarse or very dirty conductors.

The brushes can be rotated to provide new cleaning bristles and are replaceable.

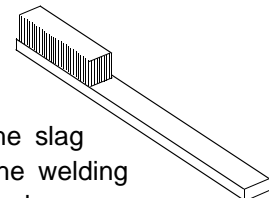

Mold brush EB-R

is useful for removing the slag from the mold after the welding connection is completed.

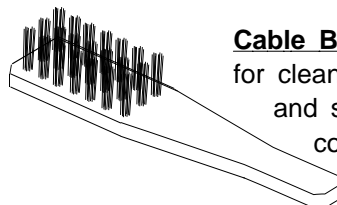

Cable Brush ET-008

is recommended for cleaning heavily oxidized conductors and surfaces prior to the welding connection.

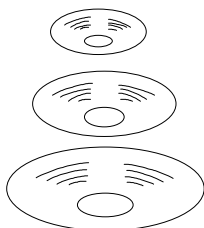

Disks

- 19mm Dia. disk : for #15 thru #65
- 26mm Dia. disk : for #90 & #115
- 38mm Dia. disk : for #150 or larger

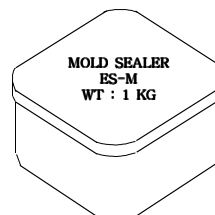

Mold Sealer ES-M

is for sealing molds to eliminate leakage of molten weld metal.

EXOWELD

Standard Connections

Cable / Cable

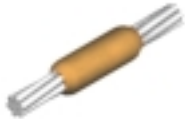

H
page 8

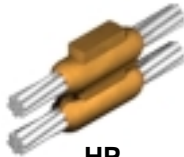

HP
page 8



HT
page 9

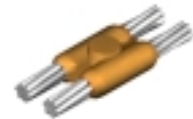

HPH
page 9



HX
page 10

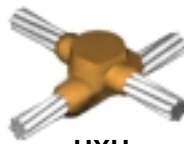

HXU
page 10



VDHT
page 11

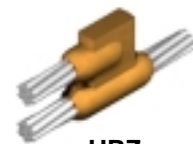

HPZ
page 11

Cable / Earth Rod



HGR
page 12



HGT
page 12

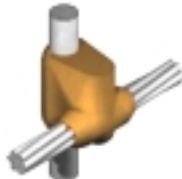

HGXU
page 13



HGV
page 13



HGP
page 14



HGVS
page 14

Cable / Steel Surface



HCHS
page 15

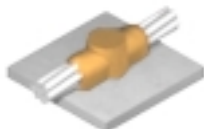

HCHST
page 15

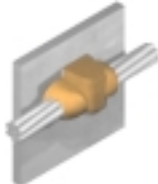

HCVS
page 16



VCVS
page 16



ADVS
page 17



HCI
page 17

Cable / Busbar or Terminal Lug



BL
page 18

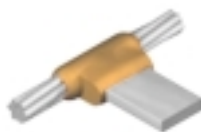

HBCT
page 18

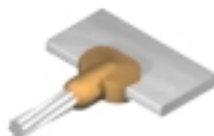

HBHC
page 19



VOVB
page 19



HBVC
page 20

EXOWELD

Standard Connections

Busbar / Busbar



VBB
page 21



HBB
page 21

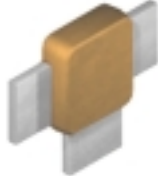

VBDT
page 22

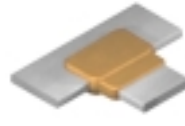

HBT
page 22

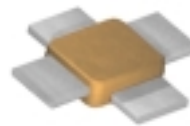

HBX
page 23



HBVB
page 23

Bus Bar / Earth Rod or Steel Surface

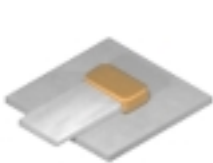

BHS
page 24



BVS
page 24

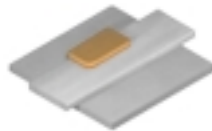

HBSS
page 25



BGRT
page 25



BGRV
page 26



BGRC
page 26

Cable / Rebar



HCHRZ
page 27



HCVRX
page 27



HCHRX
page 28



HCHRT
page 28



HCVR
page 29



VCHRX
page 29

Cable / Railway



HCR
page 30



HCHR
page 30

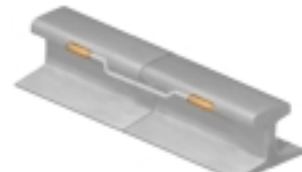

HRB
page 30

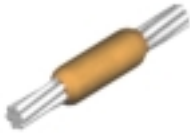

H

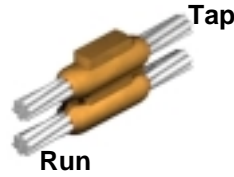

HP

Cable (mm ²)	Mold	Weld Metal	Handle Clamp	Price Key
10	H10	#32	EC-M	M
16	H16	#32	EC-M	M
25	H25	#32	EC-M	M
35	H35	#32	EC-M	M
8mm ϕ	H08 ϕ	#45	EC-M	M
50	H50	#45	EC-M	M
10mm ϕ	H10 ϕ	#65	EC-M	M
70	H70	#65	EC-M	M
95	H95	#90	EC-M	M
120	H120	#115	EC-M	M
150	H150	#115	EC-M	M
185	H185	#150	EC-M	M+
240	H240	#200	EC-M	M+
300	H300	#250	EC-M	M+
400	H400	2X#150	EC-L	M+
500	H500	2X#200	EC-L	M+

For other sizes, contact EXOTECH distributor.

Run (mm ²)	Tap (mm ²)	Mold	Weld Metal	Handle Clamp	Price Key
10	10	HP1010	#32	EC-M	M
16	16	HP1616	#45	EC-M	M
25	25	HP2525	#45	EC-M	M
35	25 35	HP3525 HP3535	#65 #65	EC-M	M
8mm ϕ	8mm ϕ	HP8 ϕ 8 ϕ	#90	EC-M	M
50	35 50	HP5035 HP5050	#90 #90	EC-M	M
10mm ϕ	10mm ϕ	HP10 ϕ 10 ϕ	#115	EC-M	H
70	50 70	HP7050 HP7070	#115 #115	EC-M	H
95	50 70 95	HP9550 HP9570 HP9595	#150 #150 #200	EC-M	H
120	70 95 120	HP12070 HP12095 HP120120	#150 #200 #250	EC-M	H
150	70 95 120 150	HP15070 HP15095 HP150120 HP150150	#150 #200 #250 2X#150	EC-M EC-M EC-M EC-L	H H H M+
185	120 150 185	HP185120 HP185150 HP185185	#250 2X#150 2X#150	EC-M EC-L EC-L	H M+ M+
240	120 150 185 240	HP240120 HP240150 HP240185 HP240240	#250 2X#150 2X#150 2X#200	EC-M EC-L EC-L EC-L	H M+ M+ M+

For other sizes, contact ECOTECH distributor.

Place the cables into position in the mold with cable ends butting together under the center of the tap hole.

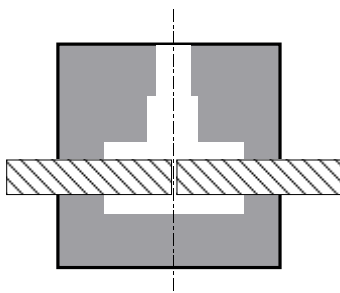

REQUIRED TOOLS	
Flint Ignitor	EF-R
SUGGESTED TOOLS	
Cable Cleaning Brush	ET-008
Mold Scraper	ET-009
Mold Brush	EB-R
Gas Torch	ET-010

Do not cut either cable unless specifically required. If the top cable is cut or is required to be cut be sure when placing the cables into position in the mold that the top cables are centered under the tap hole.

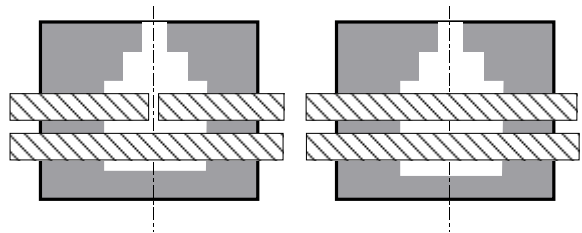

REQUIRED TOOLS	
Flint Ignitor	EF-R
SUGGESTED TOOLS	
Cable Cleaning Brush	ET-008
Mold Scraper	ET-009
Mold Brush	EB-R
Gas Torch	ET-010



HT

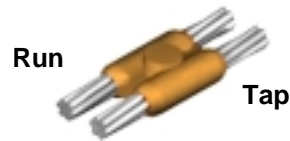

HPH

Run (mm ²)	Tap (mm ²)	Mold	Weld Metal	Handle Clamp	Price Key
10	10	HT1010	#32	EC-M	M
16	16	HT1616	#32	EC-M	M
25	10	HT2510	#32	EC-M	M
	16	HT2516	#45		
	25	HT2525	#45		
35	25	HT3525	#45	EC-M	M
	35	HT3535	#45		
8mm ϕ	8mm ϕ	HT8 ϕ 8 ϕ	#65	EC-M	M
50	25	HT5025	#65	EC-M	M
	35	HT5035	#65		
	50	HT5050	#90		
10mm ϕ	10mm ϕ	HT10 ϕ 10 ϕ	#90	EC-M	M
70	25	HT7025	#65	EC-M	M
	35	HT7035	#65		
	50	HT7050	#90		
	70	HT7070	#90		
95	35	HT9535	#90	EC-M	M
	50	HT9550	#90		
	70	HT9570	#90		
	95	HT9595	#115		
100	100	HT100100	#115	EC-M	M
120	50	HT12050	#90	EC-M	M
	70	HT12070	#90		
	95	HT12095	#150		
	120	HT120120	#150		
150	70	HT15070	#90	EC-M	M
	95	HT15095	#150		
	120	HT150120	#150		
	150	HT150150	#200		
185	95	HT18595	#150	EC-M	H
	120	HT185120	#200		
	150	HT185150	#200		
	185	HT185185	#200		

For other sizes, contact EXOTECH distributor.

Place the cables into position in the mold with the tap cable butting against the run cable.

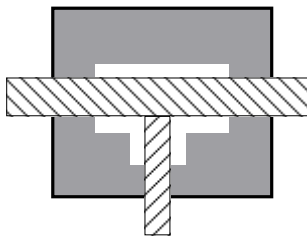

REQUIRED TOOLS

Flint Ignitor	EF-R
SUGGESTED TOOLS	
Cable Cleaning Brush	ET-008
Mold Scraper	ET-009
Mold Brush	EB-R
Gas Torch	ET-010

Run (mm ²)	Tap (mm ²)	Mold	Weld Metal	Handle Clamp	Price Key	
10	10	HPH1010	#45	EC-M	M	
16	16	HPH1616	#45	EC-M	M	
25	25	HPH2525	#45	EC-M	M	
35	25	HPH3525	#65	EC-M	M	
	35	HPH3535	#65			
8mm ϕ	8mm ϕ	HPH8 ϕ 8 ϕ	#90	EC-M	M	
50	25	HPH5025	#65	EC-M	M	
	35	HPH5035	#90			
	50	HPH5050	#90			
10mm ϕ	10mm ϕ	HPH10 ϕ 10 ϕ	#115	EC-M	M	
70	25	HPH7025	#90	EC-M	M	
	35	HPH7035	#90			
	50	HPH7050	#115			
	70	HPH7070	#115			
95	35	HPH9535	#115	EC-M	M	
	50	HPH9550	#150			
	70	HPH9570	#150			
	95	HPH9595	#150			
120	50	HPH12050	#150	EC-M	H	
	70	HPH12070	#200			
	95	HPH12095	#200			
	120	HPH120120	#200			
150	70	HPH15070	#150	EC-M	H	
	95	HPH15095	#200			
	120	HPH150120	#250			
	150	HPH150150	#250			
185	120	HPH185120	#250	EC-M	H	
	150	HPH185150	#250			
	185	HPH185185	2X#150			EC-L
240	185	HPH240185	2X#200	EC-L	L+	
	240	HPH240240	2X#250			

For other sizes, contact EXOTECH distributor.

Do not cut either cable unless specifically required. Place cables into position in the mold.

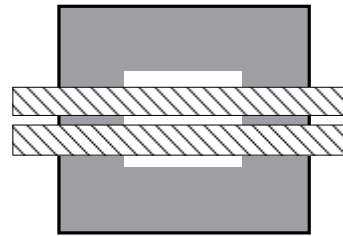

REQUIRED TOOLS

Flint Ignitor	EF-R
SUGGESTED TOOLS	
Cable Cleaning Brush	ET-008
Mold Scraper	ET-009
Mold Brush	EB-R
Gas Torch	ET-010

Run

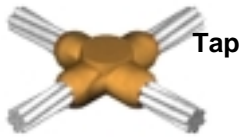

HX

Run

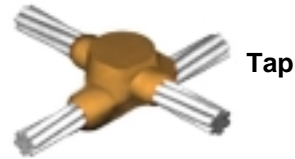

HXU

Run (mm ²)	Tap (mm ²)	Mold	Weld Metal	Handle Clamp	Price Key
10	10	HX1010	#45	EC-M	M
16	16	HX1616	#65	EC-M	M
25	25	HX2525	#45	EC-M	M
35	25	HX3525	#65	EC-M	M
		HX3535	#65		
8mm \varnothing	8mm \varnothing	HX8 \varnothing	#65	EC-M	M
50	35	HX5035	#90	EC-M	M
		HX5050	#90		
10mm \varnothing	10mm \varnothing	HX10 \varnothing	#115	EC-M	M
70	50	HX7050	#115	EC-M	M
		HX7070	#115		
95	70	HX9550	#115	EC-M	M
		HX9570	#150		H
		HX9595	#150		H
120	70	HX12070	#150	EC-M	H
		HX12095	#200		
		HX120120	#200		
150	70	HX15070	#150	EC-M	H
		HX15095	#200		
		HX150120	#250		
		HX150150	#250		
185	120	HX185120	#250	EC-M	H
		HX185150	#250	EC-M	H
		HX185185	2X#150	EC-L	L+
240	120	HX240120	2X#150	EC-L	L+
		HX240150	2X#200		
		HX240185	2X#200		
		HX240240	2X#250		

For other sizes, contact EXOTECH distributor.

The larger cable should be cut and the smaller cable placed into position so that it butts up against the larger cable.

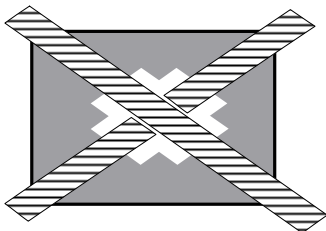

REQUIRED TOOLS	
Flint Ignitor	EF-R
SUGGESTED TOOLS	
Cable Cleaning Brush	ET-008
Mold Scraper	ET-009
Mold Brush	EB-R
Gas Torch	ET-010

Run (mm ²)	Tap (mm ²)	Mold	Weld Metal	Handle Clamp	Price Key
10	10	HXU1010	#45	EC-M	J
16	16	HXU1616	#65	EC-M	J
25	25	HXU2525	#65	EC-M	J
35	25	HXU3525	#90	EC-M	J
		HXU3535	#115		
8mm \varnothing	8mm \varnothing	HXU8 \varnothing	#115	EC-M	J
50	25	HXU5025	#115	EC-M	J
		HXU5050	#150		
10mm \varnothing	10mm \varnothing	HXU10 \varnothing	#150	EC-M	J
70	35	HXU7035	#150	EC-M	J
		HXU7050	#200		
		HXU7070	#200		
95	35	HXU9535	#200	EC-M	J
		HXU9550	#200		
		HXU9570	#250		
		HXU9595	#250		
100	100	HXU100100	#250	EC-M	J
120	50	HXU12050	#250	EC-L	J
		HXU12070	#250		
		HXU12095	2X#150		
		HXU120120	2X#150		
150	70	HXU15070	2X#150	EC-L	S
		HXU15095	2X#150		
		HXU150120	2X#200		
		HXU150150	2X#200		
185	95	HXU18595	2X#200	EC-L	S
		HXU185120	2X#250		
		HXU185150	2X#250		
		HXU185185	2X#250		
240	120	HXU240120	2X#250	EC-L	S
		HXU240150	3X#200		
		HXU240240	3X#200		

For other sizes, contact EXOTECH distributor.

Smaller size cable to be placed over the larger one.

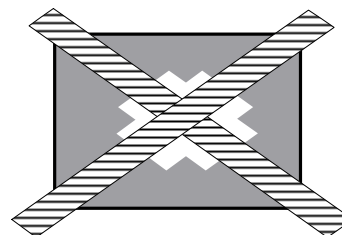

REQUIRED TOOLS	
Flint Ignitor	EF-R
SUGGESTED TOOLS	
Cable Cleaning Brush	ET-008
Mold Scraper	ET-009
Mold Brush	EB-R
Gas Torch	ET-010

Run

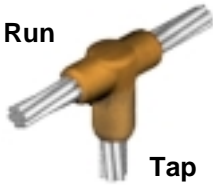

Tap

VDHT

Tap

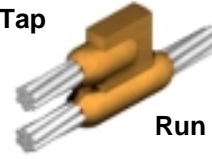

Run

HPZ

Run (mm ²)	Tap (mm ²)	Mold	Weld Metal	Handle Clamp	Price Key
10	10	VDHT1010	#32	EC-M	M
16	16	VDHT1616	#32	EC-M	M
25	25	VDHT2525	#32	EC-M	M
35	25 35	VDHT3525 VDHT3535	#45 #45	EC-M	M
50	35 50	VDHT5035 VDHT5050	#90 #90	EC-M	H
70	50 70	VDHT7050 VDHT7070	#115 #115	EC-M	H
95	50 70 95	VDHT9550 VDHT9570 VDHT9595	#150 #150 #150	EC-M	H
120	70 95 120	VDHT12070 VDHT12095 VDHT120120	#150 #150 #150	EC-M	H
150	70 95 120 150	VDHT15070 VDHT15095 VDHT150120 VDHT150150	#200 #200 #200 #200	EC-M	H
185	95 120 150 185	VDHT18595 VDHT185120 VDHT185150 VDHT185185	#200 #200 #200 #250	EC-M	H
240	120 150 185 240	VDHT240120 VDHT240150 VDHT240185 VDHT240240	#250 #250 2X#150 2X#150	EC-M EC-M EC-L EC-L	H H M+ M+

For other sizes, contact EXOTECH distributor.

Run (mm ²)	Tap (mm ²)	Mold	Weld Metal	Handle Clamp	Price Key
10	10	HPZ1010	#32	EC-M	M
16	16	HPZ1616	#32	EC-M	M
25	25	HPZ2525	#32	EC-M	M
35	25 35	HPZ3525 HPZ3535	#45 #65	EC-M	M
50	35 50	HPZ5035 HPZ5050	#65 #90	EC-M	M H
70	50 70	HPZ7050 HPZ7070	#115 #115	EC-M	H
95	50 70 95	HPZ9550 HPZ9570 HPZ9595	#115 #150 #150	EC-M	H
120	70 95 120	HPZ12070 HPZ12095 HPZ120120	#150 #200 #200	EC-M	H
150	70 95 120 150	HPZ15070 HPZ15095 HPZ150120 HPZ150150	#150 #200 #250 #250	EC-M	H
185	95 120 150 185	HPZ18595 HPZ185120 HPZ185150 HPZ185185	#150 #200 #250 #250	EC-M	H
240	120 150 185 240	HPZ240120 HPZ240150 HPZ240185 HPZ240240	#200 #250 #250 2X#150	EC-M EC-M EC-M EC-L	H H H M+

For other sizes, contact EXOTECH distributor.

Cable can be spliced with 3mm gap under the center of the tap hole.

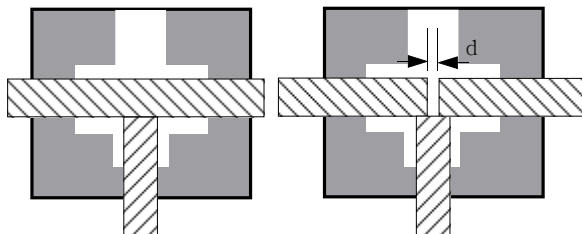

REQUIRED TOOLS	
Flint Ignitor	EF-R
SUGGESTED TOOLS	
Cable Cleaning Brush	ET-008
Mold Scraper	ET-009
Mold Brush	EB-R
Gas Torch	ET-010

Do not cut run cable.
Place tap cable end under the center of the tap hole.

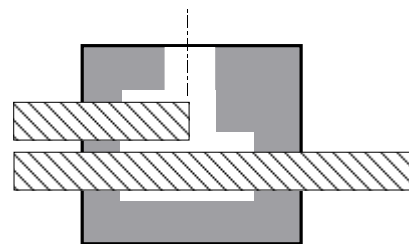

REQUIRED TOOLS	
Flint Ignitor	EF-R
SUGGESTED TOOLS	
Cable Cleaning Brush	ET-008
Mold Scraper	ET-009
Mold Brush	EB-R
Gas Torch	ET-010



HGR



HGT

Earth rod Dia (mm)	Cable (mm ²)	Mold	Weld Metal	Handle Clamp	Price Key
11.1	25	HGR1125	#65	EC-M	H
	35	HGR1135	#65		
	50	HGR1150	#65		
	70	HGR1170	#90		
	95	HGR1195	#90		
	120	HGR11120	#90		
12.7	150	HGR11150	#90		
	25	HGR1225	#65	EC-M	H
	35	HGR1235	#65		
	50	HGR1250	#65		
	70	HGR1270	#90		
	95	HGR1295	#90		
120	HGR12120	#90			
14.2	150	HGR12150	#115		
	25	HGR1425	#65	EC-M	H
	35	HGR1435	#90		
	50	HGR1450	#90		
	70	HGR1470	#90		
	95	HGR1495	#90		
120	HGR14120	#90			
17.1	150	HGR14150	#115		
	185	HGR14185	#150		
	240	HGR14240	#150		
	25	HGR1725	#65	EC-M	H
	35	HGR1735	#90		
	50	HGR1750	#90		
70	HGR1770	#90			
95	HGR1795	#90			
120	HGR17120	#90			
17.1	150	HGR17150	#115		
	185	HGR17185	#150		
	240	HGR17240	#150		

For other sizes, contact EXOTECH distributor.

Place the rod and cable into position in the mold. The cable end should sit on top of the rod and be positioned 3mm short of the center of the tap hole.

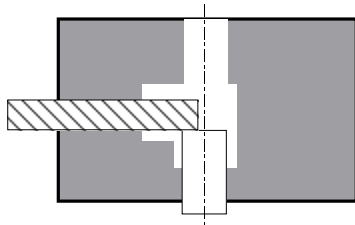

REQUIRED TOOLS

Flint Ignitor	EF-R
SUGGESTED TOOLS	
Cable Cleaning Brush	ET-008
Mold Scraper	ET-009
Mold Brush	EB-R
Gas Torch	ET-010

Earth rod Dia. (mm)	Cable (mm ²)	Mold	Weld Metal	Handle Clamp	Price Key
11.1	25	HGT1125	#90	EC-M	H
	35	HGT1135	#90		
	50	HGT1150	#90		
	70	HGT1170	#90		
	95	HGT1195	#115		
	120	HGT11120	#150		
12.7	150	HGT11150	#150		
	25	HGT1225	#90	EC-M	H
	35	HGT1235	#90		
	50	HGT1250	#90		
	70	HGT1270	#90		
	95	HGT1295	#115		
120	HGT12120	#150			
14.2	150	HGT12150	#150		
	185	HGT12185	#200		
	25	HGT1425	#90	EC-M	H
	35	HGT1435	#90		
	50	HGT1450	#90		
	70	HGT1470	#115		
95	HGT1495	#115			
120	HGT14120	#150			
17.1	150	HGT14150	#200		
	185	HGT14185	#200		
	240	HGT14240	#250		
	25	HGT1725	#90	EC-M	H
	35	HGT1735	#90		
	50	HGT1750	#115		
70	HGT1770	#115			
95	HGT1795	#115			
120	HGT17120	#150			
17.1	150	HGT17150	#200		
	185	HGT17185	#200		
	240	HGT17240	#250		

For other sizes, contact EXOTECH distributor.

Place the rod and cables into position in the mold. The cable should be positioned on top of the rod and be spliced with 3mm gap under the center of the tap hole.

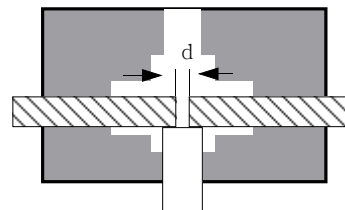

REQUIRED TOOLS

Flint Ignitor	EF-R
SUGGESTED TOOLS	
Cable Cleaning Brush	ET-008
Mold Scraper	ET-009
Mold Brush	EB-R
Gas Torch	ET-010

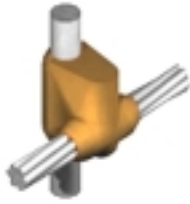

HGXU



HGV

Earth rod Dia (mm)	cable (mm ²)	Mold	Weld Metal	Handle Clamp	Price Key
11.1	25	HGXU1125	#90	EC-M	M+
	35	HGXU1135	#90		
	50	HGXU1150	#115		
	70	HGXU1170	#115		
	95	HGXU1195	#115		
	120	HGXU11120	#150		
12.7	150	HGXU11150	#200	EC-M	M+
	25	HGXU1225	#90		
	35	HGXU1235	#90		
	50	HGXU1250	#115		
	70	HGXU1270	#115		
	95	HGXU1295	#115		
	120	HGXU12120	#150		
150	HGXU12150	#200			
14.2	185	HGXU12185	#200	EC-M	M+
	240	HGXU1240	2X#200		
	25	HGXU1425	#90		
	35	HGXU1435	#90		
	50	HGXU1450	#115		
	70	HGXU1470	#115		
	95	HGXU1495	#115		
	120	HGXU14120	#150		
150	HGXU14150	#200			
17.1	185	HGXU14185	#250	EC-M	M+
	240	HGXU14240	2X#200		
	25	HGXU1725	#90		
	35	HGXU1735	#90		
	50	HGXU1750	#115		
	70	HGXU1770	#150		
	95	HGXU1795	#150		
	120	HGXU17120	#200		
150	HGXU17150	#250			
185	HGXU17185	2X#200			
240	HGXU17240	2X#250			

For other sizes, contact EXOTECH distributor.

Place the rod and cable into position in the mold. Secure the back plate into position so that it encloses the rod. The mold should be supported with vice grip pliers or via a clamp on the rod.

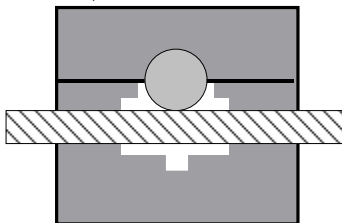

REQUIRED TOOLS

Flint Ignitor	EF-R
SUGGESTED TOOLS	
Cable Cleaning Brush	ET-008
Mold Scraper	ET-009
Mold Brush	EB-R
Gas Torch	ET-010
Vice Grip Pliers	ET-007-1

Earth rod Dia (mm)	cable (mm ²)	Mold	Weld Metal	Handle Clamp	Price Key
12.7	35	HGV1235	#90	EC-M	M+
	120	HGV12120	#150		
15.8	50	HGV1550	#115	EC-M	M+
	80	HGV1580	#115		
	100	HGV15100	#115		
19.0	22	HGV1922	#65	EC-M	M+
	60	HGV1960	#115		
	100	HGV19100	#115		

For other sizes, contact EXOTECH distributor.

Place the rod and cable into position in the mold. The mold should be supported with vice grip pliers or via a clamp on the rod.

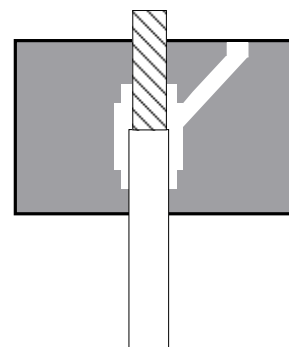

REQUIRED TOOLS

Flint Ignitor	EF-R
SUGGESTED TOOLS	
Cable Cleaning Brush	ET-008
Mold Scraper	ET-009
Mold Brush	EB-R
Gas Torch	ET-010
Vice Grip Pliers	ET-007-1

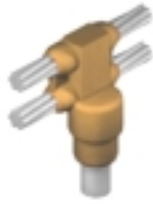

HGP



HGVS

Earth rod Dia. (mm)	Cable (mm ²)	Mold	Weld Metal	Handle Clamp	Price Key
11.1	25	HGP1125	#115	EC-M	H
	35	HGP1135	#115	EC-M	H
	50	HGP1150	#150	EC-M	H
	70	HGP1170	#250	EC-M	H
	95	HGP1195	#250	EC-M	H
	120	HGP11120	2X#150	EC-L	M+
	150	HGP11150	2X#200	EC-L	M+
12.7	25	HGP1225	#115	EC-M	H
	35	HGP1235	#150	EC-M	H
	50	HGP1250	#150	EC-M	H
	70	HGP1270	#250	EC-M	H
	95	HGP1295	#250	EC-M	H
	120	HGP12120	2X#150	EC-L	M+
	150	HGP12150	2X#200	EC-L	M+
14.2	25	HGP1425	#115	EC-M	H
	35	HGP1435	#150	EC-M	H
	50	HGP1450	#200	EC-M	H
	70	HGP1470	2X#150	EC-L	M+
	95	HGP1495	2X#150	EC-L	M+
	120	HGP14120	2X#200	EC-L	M+
	150	HGP14150	2X#200	EC-L	M+
	185	HGP14185	2X#250	EC-L	M+
240	HGP14240	2X#250	EC-L	M+	
17.1	25	HGP1725	#115	EC-M	H
	35	HGP1735	#115	EC-M	H
	50	HGP1750	#200	EC-M	H
	70	HGP1770	2X#150	EC-L	M+
	95	HGP1795	2X#150	EC-L	M+
	120	HGP17120	2X#200	EC-L	M+
	150	HGP17150	2X#250	EC-L	M+
	185	HGP17185	2X#250	EC-L	M+
	240	HGP17240	3X#200	EC-L	M+
	300	HGP17300	3X#250	EC-L	M+

For other sizes, contact EXOTECH distributor.

Place the rod and cables into position in the mold. The top cable should be placed on top of the rod and be spliced with a 3mm gap under the center of the tap hole.

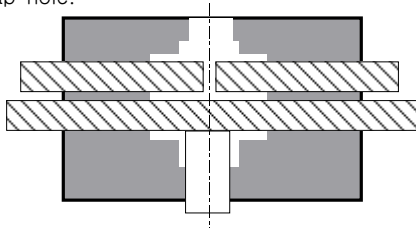

REQUIRED TOOLS	
Flint Ignitor	EF-R
SUGGESTED TOOLS	
Cable Cleaning Brush	ET-008
Mold Scraper	ET-009
Mold Brush	EB-R
Gas Torch	ET-010

Earth rod Dia. (mm)	Cable (mm ²)	Mold	Weld Metal	Handle Clamp	Price Key
11.1	25	HGVS1125	#90	EC-M	M+
	35	HGVS1135	#90		
	50	HGVS1150	#90		
	70	HGVS1170	#90		
	95	HGVS1195	#115		
	120	HGVS11120	#150		
	150	HGVS11150	#200		
12.7	25	HGVS1225	#90	EC-M	M+
	35	HGVS1235	#90		
	50	HGVS1250	#90		
	70	HGVS1270	#90		
	95	HGVS1295	#115		
	120	HGVS12120	#150		
	150	HGVS12150	#150		
	185	HGVS12185	#200		
14.2	25	HGVS1425	#90	EC-M	M+
	35	HGVS1435	#90		
	50	HGVS1450	#90		
	70	HGVS1470	#115		
	95	HGVS1495	#115		
	120	HGVS14120	#150		
	150	HGVS14150	#200		
	185	HGVS14185	#200		
240	HGVS14240	#250			
17.1	25	HGVS1725	#90	EC-M	M+
	35	HGVS1735	#90		
	50	HGVS1750	#115		
	70	HGVS1770	#115		
	95	HGVS1795	#115		
	120	HGVS17120	#150		
	150	HGVS17150	#200		
	185	HGVS17185	#200		
	240	HGVS17240	#250		

For other sizes, contact EXOTECH distributor.

Place the rod and cable into position in the mold. The mold should be supported with vice grip pliers or via a clamp on the rod.

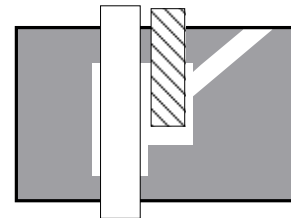

REQUIRED TOOLS	
Flint Ignitor	EF-R
SUGGESTED TOOLS	
Cable Cleaning Brush	ET-008
Mold Scraper	ET-009
Mold Brush	EB-R
Gas Torch	ET-010
Vice Grip Pliers	ET-007-1



HCHS



HCHST

Cable (mm ²)	Mold	Weld Metal	Handle Clamp	Price Key
10	HCHS10	#45	EC-M	F
16	HCHS16	#45	EC-M	F
25	HCHS25	#45	EC-M	F
35	HCHS35	#65	EC-M	F
8mm ϕ	HCHS8 ϕ	#90	EC-M	M
50	HCHS50	#90	EC-M	M
10mm ϕ	HCHS10 ϕ	#90	EC-M	M
70	HCHS70	#90	EC-M	M
95	HCHS95	#115	EC-M	H
120	HCHS120	#115	EC-M	H
150	HCHS150	#150	EC-M	H
185	HCHS185	#200	EC-M	H
240	HCHS240	#200	EC-M	H
300	HCHS300	#250	EC-M	H

For other sizes, contact EXOTECH distributor.

Place the cable end 3mm short of the center of the tap hole.
Pressure must be applied to the closed mold cover to hold the mold in place.

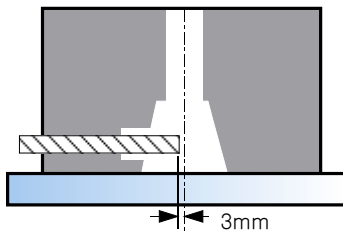

REQUIRED TOOLS	
Flint Ignitor	EF-R
SUGGESTED TOOLS	
Cable Cleaning Brush	ET-008
Mold Scraper	ET-009
Mold Brush	EB-R
Gas Torch	ET-010

Cable (mm ²)	Mold	Weld Metal	Handle Clamp	Price Key
10	HCHST10	#65	EC-M	F
16	HCHST16	#65	EC-M	F
25	HCHST25	#65	EC-M	F
35	HCHST35	#90	EC-M	M
8mm ϕ	HCHST8 ϕ	#90	EC-M	M
50	HCHST50	#90	EC-M	M
10mm ϕ	HCHST10 ϕ	#115	EC-M	H
70	HCHST70	#115	EC-M	H
95	HCHST95	#115	EC-M	H
120	HCHST120	#150	EC-M	H
150	HCHST150	#200	EC-M	H
185	HCHST185	#250	EC-M	H
240	HCHST240	2X#150	EC-M	M+
300	HCHST300	2X#200	EC-M	M+

For other sizes, contact EXOTECH distributor.

For cable over 50mmsq in size, cut the cable and place in position leaving a gap of 3mm under the center of the tap hole.
Pressure must be applied to the closed mold cover to hold the mold in place.

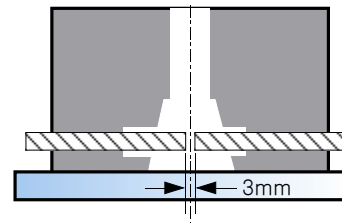

REQUIRED TOOLS	
Flint Ignitor	EF-R
SUGGESTED TOOLS	
Cable Cleaning Brush	ET-008
Mold Scraper	ET-009
Mold Brush	EB-R
Gas Torch	ET-010

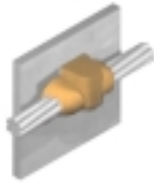

HCVS



VCVS

Cable (mm ²)	Mold	Weld Metal	Handle Clamp	Price Key
10	HCVS10	#45	EC-M	M+
16	HCVS16	#45	EC-M	M+
25	HCVS25	#45	EC-M	M+
35	HCVS35	#45	EC-M	M+
8mm ϕ	HCVS8 ϕ	#65	EC-M	M+
50	HCVS50	#90	EC-M	M+
10mm ϕ	HCVS10 ϕ	#115	EC-M	M+
70	HCVS70	#115	EC-M	M+
95	HCVS95	#150	EC-M	M+
120	HCVS120	#150	EC-M	M+
150	HCVS150	#200	EC-M	M+
185	HCVS185	#250	EC-M	M+
240	HCVS240	2X#150	EC-L	L+
300	HCVS300	2X#200	EC-L	L+

For other sizes, contact EXOTECH distributor.

Cable (mm ²)	Mold	Weld Metal	Handle Clamp	Price Key
10	VCVS10	#45	EC-M	M+
16	VCVS16	#65	EC-M	M+
25	VCVS25	#65	EC-M	M+
35	VCVS35	#46	EC-M	M+
8mm ϕ	VCVS8 ϕ	#90	EC-M	M+
50	VCVS50	#115	EC-M	M+
10mm ϕ	VCVS10 ϕ	#150	EC-M	M+
70	VCVS70	#150	EC-M	M+
95	VCVS95	#200	EC-M	M+
120	VCVS120	#200	EC-M	M+
150	VCVS150	#250	EC-M	M+
185	VCVS185	2X#150	EC-M	L+
240	VCVS240	2X#200	EC-M	L+
300	VCVS300	2X#250	EC-M	L+

For other sizes, contact EXOTECH distributor.

Place the cable into position in the mold and secure the mold to the steel surface using a C clamp. Fill the gap around the cable with packing sealer.

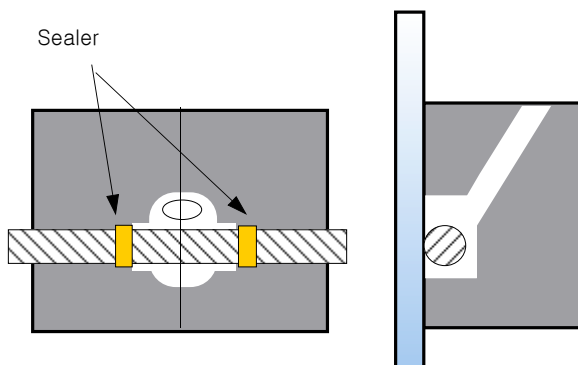

REQUIRED TOOLS	
Flint Ignitor	EF-R
SUGGESTED TOOLS	
Cable Cleaning Brush	ET-008
Mold Scraper	ET-009
Mold Brush	EB-R
Gas Torch	ET-010
Packing Seal	ES-M

Place the cable into position in the mold ensuring that it is firmly against the steel surface. The end of the cable must be positioned against the bottom of the weld cavity. The mold should be secured to the steel surface using a C clamp.

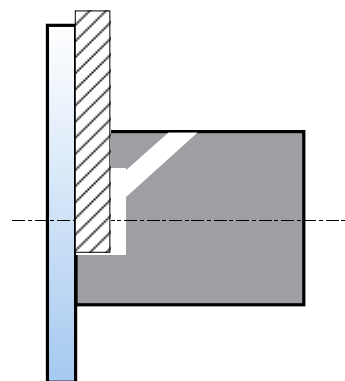

REQUIRED TOOLS	
Flint Ignitor	EF-R
SUGGESTED TOOLS	
Cable Cleaning Brush	ET-008
Mold Scraper	ET-009
Mold Brush	EB-R
Gas Torch	ET-010



ADVS



HCI

Cable (mm ²)	Mold	Weld Metal	Handle Clamp	Price Key
25	ADVS25	#45	EC-M	M
35	ADVS35	#45	EC-M	M
50	ADVS50	#90	EC-M	M
70	ADVS70	#90	EC-M	M
95	ADVS95	#115	EC-M	H
120	ADVS120	#115	EC-M	H
150	ADVS150	#150	EC-M	H
185	ADVS185	#200	EC-M	H
240	ADVS240	#200	EC-M	H

For other sizes, contact EXOTECH distributor.

Place the cable and mold into position as shown. Secure mold to the surface using a C clamp.

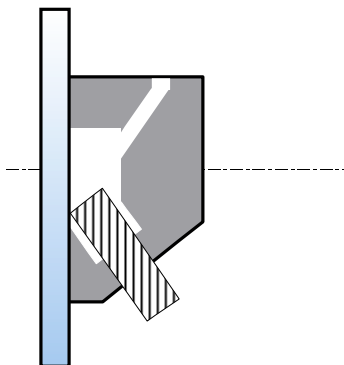

REQUIRED TOOLS	
Flint Ignitor	EF-R
SUGGESTED TOOLS	
Cable Cleaning Brush	ET-008
Mold Scraper	ET-009
Mold Brush	EB-R
Gas Torch	ET-010

Cable (mm ²)	Mold	Weld Metal	Handle Clamp	Price Key
10	HCI10/ø*	#25	EC-M	F
16	HCI16/ø*	#32	EC-M	F
25	HCI25/ø*	#45	EC-M	F
35	HCI35/ø*	#45	EC-M	F
8mmø	HCIø8/ø*	#45	EC-M	M
50	HCI50/ø*	#45	EC-M	M
10mmø	HCIø10/ø*	#65	EC-M	M
70	HCI70/ø*	#65	EC-M	M
95	HCI95/ø*	#115	EC-M	H
120	HCI120/ø*	#115	EC-M	H
150	HCI150/ø*	#150	EC-M	H
185	HCI185/ø*	#200	EC-M	H
240	HCI240/ø*	#200	EC-M	H
300	HCI300/ø*	#250	EC-M	H

For other sizes, contact EXOTECH distributor.

Specify the diameter of the pipe. Place cable end into position so that it is 3mm short of the center of the tap hole. Pressure must be applied to the closed mold cover to hold the mold in place. The gap around the cable should be filled with packing sealer.

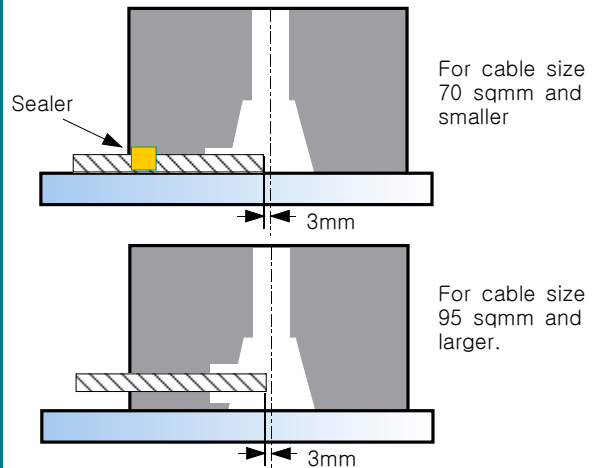

REQUIRED TOOLS	
Flint Ignitor	EF-R
SUGGESTED TOOLS	
Cable Cleaning Brush	ET-008
Mold Scraper	ET-009
Mold Brush	EB-R
Gas Torch	ET-010
Packing Seal	ES-M

BUS or LUG



BL

BUS or LUG

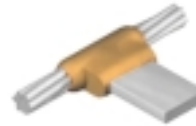

HBCT

BUS (mm)	Cable (mm ²)	Mold	Weld Metal	Handle Clamp	Price Key
20X2	10 25	BL10/202 BL25/202	#32 #32	EC-M	M
25X3	35 8mm ϕ 70	BL35/253 BL8 ϕ /253 BL70/253	#45 #65 #65	EC-M	M
30X2	25 35 50	BL25/302 BL35/302 BL50/302	#45 #45 #45	EC-M	M
30X3	35 8mm ϕ 50 10mm ϕ 70	BL35/303 BL8 ϕ /303 BL50/303 BL10 ϕ /303 BL70/303	#45 #65 #65 #90 #90	EC-M	M
30X5	95 120 150	BL95/305 BL120/305 BL150/305	#90 #115 #115	EC-M	M
40X3	70 95 120	BL70/403 BL95/403 BL120/403	#90 #90 #115	EC-M	H
40X5	120 150 185	BL120/405 BL150/405 BL185/405	#115 #150 #150	EC-M	H
50X5	150 185 240	BL150/505 BL185/505 BL240/505	#150 #200 #200	EC-M	H
60X5	185 240 300	BL185/605 BL240/605 BL300/605	#250 #250 2X#150	EC-M EC-M EC-L	L+

For other sizes, contact EXOTECH distributor.

BUS (mm)	Cable (mm ²)	Mold	Weld Metal	Handle Clamp	Price Key
20X2	10 25	HBCT10/202 HBCT25/202	#45 #45	EC-M	M
25X3	35 50 10mm ϕ 70	HBCT35/253 HBCT50/253 HBCT10 ϕ /253 HBCT70/253	#65 #65 #115 #90	EC-M	M
30X2	25 35 8mm ϕ 50	HBCT25/302 HBCT35/302 HBCT8 ϕ /302 HBCT50/302	#45 #45 #65 #65	EC-M	M
30X3	35 8mm ϕ 50 10mm ϕ 70	HBCT35/303 HBCT8 ϕ /303 HBCT50/303 HBCT10 ϕ /303 HBCT70/303	#65 #90 #90 #115 #115	EC-M	M
30X5	95 120 150	HBCT95/305 HBCT120/305 HBCT150/305	#150 #200 #200	EC-M	H
40X3	70 95 120	HBCT70/403 HBCT95/403 HBCT120/403	#115 #150 #200	EC-M	H
40X5	120 150 185	HBCT120/405 HBCT150/405 HBCT185/405	#200 #250 #250	EC-M	H
50X5	150 185 240	HBCT150/505 HBCT185/505 HBCT240/505	#250 2X#150 2X#150	EC-M EC-L EC-L	H M+ M+
60X5	185 240 300	HBCT185/605 HBCT240/605 HBCT300/605	2X#150 2X#200 2X#250	EC-L	M+

For other sizes, contact EXOTECH distributor.

Place the cable and lug/bus into position in the mold with ends butted center of the tap hole.

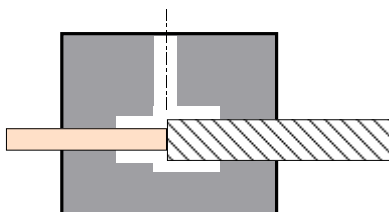

Place the cable and lug/bus into position in the mold, with lug/bus butted against the side of the cable.

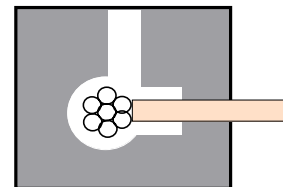

REQUIRED TOOLS	
Flint Ignitor	EF-R
SUGGESTED TOOLS	
Cable Cleaning Brush	ET-008
Mold Scraper	ET-009
Mold Brush	EB-R
Gas Torch	ET-010

REQUIRED TOOLS	
Flint Ignitor	EF-R
SUGGESTED TOOLS	
Cable Cleaning Brush	ET-008
Mold Scraper	ET-009
Mold Brush	EB-R
Gas Torch	ET-010

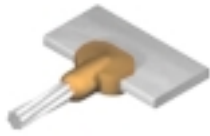

HBHC



VOCB

BUS (mm)	Cable (mm ²)	Mold	Weld Metal	Handle Clamp	Price Key
25X3	35	HBHC35/253	#45	EC-M	M
	50	HBHC50/253	#45		
	70	HBHC70/253	#65		
30X3	35	HBHC35/303	#45	EC-M	M
	50	HBHC50/303	#65		
	70	HBHC70/303	#90		
30X5	95	HBHC95/305	#90	EC-M	M
	120	HBHC120/305	#115		
	150	HBHC150/305	#115		
40X3	70	HBHC70/403	#90	EC-M	M
	95	HBHC95/403	#90		
	120	HBHC120/403	#115		
40X5	35	HBHC35/405	#65	EC-M	M
	50	HBHC50/405	#65		M
	70	HBHC70/405	#90		M
	95	HBHC95/405	#90		M
	120	HBHC120/405	#115		M
	150	HBHC150/405	#150		H
185	HBHC185/405	#150	H		
50X5	70	HBHC70/505	#90	EC-M	H
	95	HBHC95/505	#90		
	120	HBHC120/505	#115		
	150	HBHC150/505	#150		
	185	HBHC185/505	#150		
240	HBHC240/505	#200			
60X5	150	HBHC150/605	#150	EC-M	H
	185	HBHC185/605	#150		
	240	HBHC240/605	#200		

For other sizes, contact EXOTECH distributor.

Place the cable and bus bar into position in the mold ensuring the cable butts against the bus bar. The mold should be tightly seated on the bus bar.

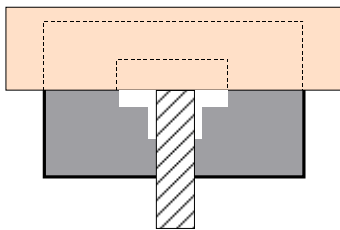

REQUIRED TOOLS	
Flint Ignitor	EF-R
SUGGESTED TOOLS	
Cable Cleaning Brush	ET-008
Mold Scraper	ET-009
Mold Brush	EB-R
Gas Torch	ET-010

BUS (mm)	Cable (mm ²)	Mold	Weld Metal	Handle Clamp	Price Key
3X25 & WIDER	35	VOCB35/3	#115	EC-M	M+
	50	VOCB50/3	#115		
	70	VOCB70/3	#115		
	95	VOCB95/3	#115		
	120	VOCB120/3	#115		
5X25 & WIDER	150	VOCB150/3	#150	EC-M	M+
	50	VOCB50/5	#150		
	70	VOCB70/5	#150		
	95	VOCB95/5	#150		
	120	VOCB120/5	#150		
	150	VOCB150/5	#200		
10X30 & WIDER	185	VOCB185/5	#200	EC-M	M+
	240	VOCB240/5	2X#150		
	50	VOCB50/10	#150		
	70	VOCB70/10	#150		
	95	VOCB95/10	#150		
	125	VOCB125/10	#150		
	150	VOCB150/10	#200		
185	VOCB185/10	#200			
240	VOCB240/10	#250			
300	VOCB300/10	2X#150			

For other sizes, contact EXOTECH distributor.

Place the cable and bus bar into position in the mold. Ensure there is a 3-5 mm gap between cable and the bus bar.

Use pliers to hold the cable and confirm the mold is tightly seated on the bus bar.

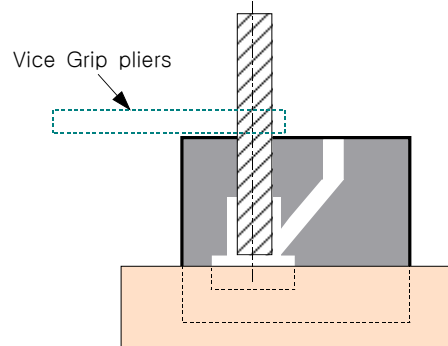

REQUIRED TOOLS	
Flint Ignitor	EF-R
SUGGESTED TOOLS	
Cable Cleaning Brush	ET-008
Mold Scraper	ET-009
Mold Brush	EB-R
Gas Torch	ET-010
Vice Grip Pliers	ET-007-1

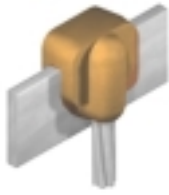

HBVC

BUS (mm)	Cable (mm ²)	Mold	Weld Metal	Handle Clamp	Price Key
3X25 & WIDER	50	HBVC50/3	#90	EC-M	H
	70	HBVC70/3	#90		
	95	HBVC95/3	#115		
	120	HBVC120/3	#115		
	150	HBVC150/3	#150		
5X25 & WIDER	185	HBVC185/3	#150	EC-M	H
	50	HBVC50/5	#115		
	70	HBVC70/5	#115		
	95	HBVC95/5	#150		
	120	HBVC120/5	#150		
	150	HBVC150/5	#200		
10X50 & WIDER	185	HBVC185/5	#200	EC-M	H
	240	HBVC240/5	#250		
	50	HBVC50/10	#115		
	70	HBVC70/10	#115		
	95	HBVC95/10	#150		
	120	HBVC120/10	#150		
	150	HBVC150/10	#200		
	185	HBVC185/10	#200		
	240	HBVC240/10	#250		
	300	HBVC300/10	#250		
400	HBVC400/10	2X#200	EC-L	M+	
500	HBVC500/10	2X#250	EC-L	M+	

For other sizes, contact EXOTECH distributor.

Place the cable and bus bar into position in the mold ensuring the cable end is even with the top of the bus bar.

Use packing material around the cable to avoid leaking.

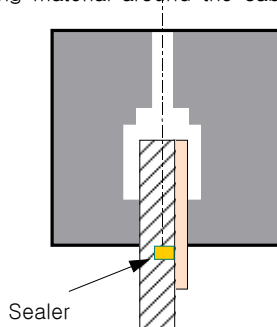

REQUIRED TOOLS

Flint Ignitor	EF-R
---------------	------

SUGGESTED TOOLS

Cable Cleaning Brush	ET-008
Mold Scraper	ET-009
Mold Brush	EB-R
Gas Torch	ET-010
Packing Seal	ES-M



Run

VBB

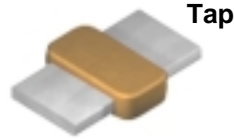

Run

HBB

Run (mm)	Tap (mm)	Mold	Weld Metal	Handle Clamp	Price Key
20X2	20X2	VBB202	#45	EC-M	M
20X3	20X3	VBB203	#45	EC-M	M
20X5	20X5	VBB205	#65	EC-M	M
25X3	25X3	VBB253	#65	EC-M	M
25X4	25X4	VBB254	#90	EC-M	H
30X2	30X2	VBB302	#65	EC-M	H
30X3	30X3	VBB303	#90	EC-M	H
30X4	30X4	VBB304	#115	EC-M	H
40X3	40X3	VBB403	#115	EC-M	H
40X4	40X4	VBB404	#150	EC-M	H
40X5	40X5	VBB405	#150	EC-M	H
40X6	40X6	VBB406	#200	EC-M	H
40X10	40X10	VBB4010	#250	EC-M	H
50X5	50X5	VBB505	#200	EC-M	H
50X6	50X6	VBB506	#250	EC-M	H
50X8	50X8	VBB508	2X#150	EC-L	M+
50X10	50X10	VBB5010	2X#200	EC-L	M+
60X5	60X5	VBB605	2X#150	EC-L	M+
60X10	60X10	VBB6010	2X#250	EC-L	M+
80X5	80X5	VBB805	2X#200	EC-L	M+
80X10	80X10	VBB8010	3X#200	EC-L	M+
100X5	100X5	VBB1005	2X#250	EC-L	M+
100X10	100X10	VBB10010	3X#250	EC-L	M+

For other sizes, contact EXOTECH distributor.

Run (mm)	Tap (mm)	Mold	Weld Metal	Handle Clamp	Price Key
20X2	20X2	HBB202	#45	EC-M	M
20X3	20X3	HBB203	#45	EC-M	M
20X5	20X5	HBB205	#90	EC-M	M
25X2	25X2	HBB252	#45	EC-M	M
25X3	25X3	HBB253	#65	EC-M	M
25X4	25X4	HBB254	#90	EC-M	M
30X2	30X2	HBB302	#65	EC-M	M
30X3	30X3	HBB303	#65	EC-M	M
30X4	30X4	HBB304	#90	EC-M	M
30X5	30X5	HBB305	#115	EC-M	M
40X3	40X3	HBB403	#90	EC-M	M
40X4	40X4	HBB404	#115	EC-M	M
40X5	40X5	HBB405	#150	EC-M	H
40X6	40X6	HBB406	#200	EC-M	H
40X10	40X10	HBB4010	2X#150	EC-L	L+
50X5	50X5	HBB505	#200	EC-M	L+
50X6	50X6	HBB506	#250	EC-M	L+
50X8	50X8	HBB508	2X#150	EC-L	L+
50X10	50X10	HBB5010	2X#200	EC-L	L+
60X5	60X5	HBB605	2X#150	EC-L	L+
60X10	60X10	HBB6010	2X#250	EC-L	L+
80X5	80X5	HBB805	2X#200	EC-L	L+
80X10	80X10	HBB8010	3X#200	EC-L	L+

For other sizes, contact EXOTECH distributor.

Place bars into position in the mold. Ensure gap between bars is centered under the tap hole.
 For thickness ≤ 3mm : gap = 3mm
 For thickness > 3mm : gap = 5~6mm

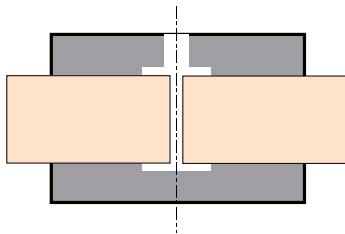

REQUIRED TOOLS

Flint Ignitor	EF-R
SUGGESTED TOOLS	
Cable Cleaning Brush	ET-008
Mold Scraper	ET-009
Mold Brush	EB-R
Gas Torch	ET-010

Place bars into position in the mold. Ensure gap between bars is centered under the tap hole.
 For thickness ≤ 3mm : gap = 3mm
 For thickness > 3mm : gap = 5~6mm

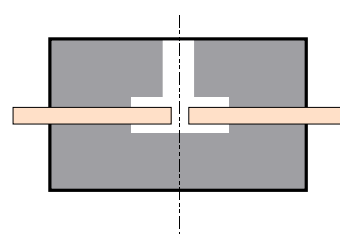

REQUIRED TOOLS

Flint Ignitor	EF-R
SUGGESTED TOOLS	
Cable Cleaning Brush	ET-008
Mold Scraper	ET-009
Mold Brush	EB-R
Gas Torch	ET-010

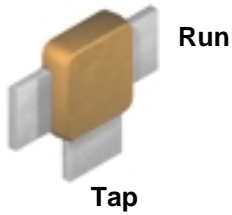

VBDT

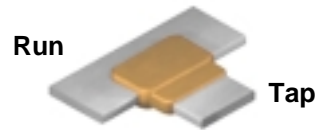

HBT

Run (mm)	Tap (mm)	Mold	Weld Metal	Handle Clamp	Price Key
20X2	20X2	VBDT202	#45	EC-M	M
20X3	20X3	VBDT203	#65	EC-M	M
20X5	20X5	VBDT205	#65	EC-M	M
25X2	25X2	VBDT252	#65	EC-M	M
25X3	25X3	VBDT253	#65	EC-M	M
25X4	25X4	VBDT254	#90	EC-M	H
30X2	30X2	VBDT302	#65	EC-M	H
30X3	30X3	VBDT303	#90	EC-M	H
30X4	30X4	VBDT304	#115	EC-M	H
30X5	30X5	VBDT305	#115	EC-M	H
40X3	40X3	VBDT403	#115	EC-M	H
40X4	40X4	VBDT404	#150	EC-M	H
40X5	40X5	VBDT405	#150	EC-M	H
40X6	40X6	VBDT406	#200	EC-M	H
40X10	40X10	VBDT4010	2X#150	EC-L	M+
50X5	50X5	VBDT505	#200	EC-M	M+
50X6	50X6	VBDT506	#250	EC-M	M+
50X8	50X8	VBDT508	2X#150	EC-L	M+
50X10	50X10	VBDT5010	2X#200	EC-L	M+
60X5	60X5	VBDT605	2X#150	EC-L	M+
60X10	60X10	VBDT6010	2X#250	EC-L	M+
80X5	80X5	VBDT805	2X#200	EC-L	M+
80X10	80X10	VBDT8010	3X#200	EC-L	M+

For other sizes, contact EXOTECH distributor.

Run (mm)	Tap (mm)	Mold	Weld Metal	Handle Clamp	Price Key
20X2	20X2	HBT202	#45	EC-M	M
20X5	20X5	HBT205	#65	EC-M	M
25X2	25X2	HBT252	#45	EC-M	M
25X3	25X3	HBT253	#65	EC-M	M
25X4	25X4	HBT254	#90	EC-M	M
30X2	30X2	HBT302	#65	EC-M	M
30X3	30X3	HBT303	#65	EC-M	M
30X4	30X4	HBT304	#90	EC-M	M
30X5	30X5	HBT305	#115	EC-M	M
40X3	40X3	HBT403	#90	EC-M	M
40X4	40X4	HBT404	#115	EC-M	M
40X5	40X5	HBT405	#150	EC-M	H
40X6	40X6	HBT406	#200	EC-M	H
40X10	40X10	HBT4010	2X#150	EC-L	L+
50X5	50X5	HBT505	#200	EC-M	L+
50X6	50X6	HBT506	#250	EC-M	L+
50X8	50X8	HBT508	2X#150	EC-L	L+
50X10	50X10	HBT5010	2X#200	EC-L	L+
60X5	60X5	HBT605	2X#150	EC-L	L+
60X10	60X10	HBT6010	2X#250	EC-L	L+
80X5	80X5	HBT805	2X#200	EC-L	L+
80X10	80X10	HBT8010	3X#200	EC-L	L+

For other sizes, contact EXOTECH distributor.

Place bars into position in the mold with the end of the tap bar even with the top edge of the run bar.

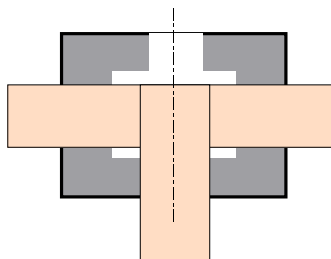

REQUIRED TOOLS	
Flint Ignitor	EF-R
SUGGESTED TOOLS	
Cable Cleaning Brush	ET-008
Mold Scraper	ET-009
Mold Brush	EB-R
Gas Torch	ET-010

Place bars into position in the mold ensuring both run and tap bars are tightly seated in position.

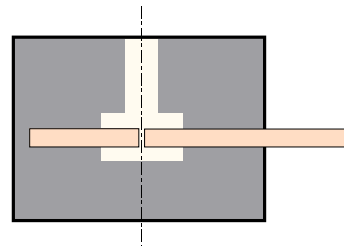

REQUIRED TOOLS	
Flint Ignitor	EF-R
SUGGESTED TOOLS	
Cable Cleaning Brush	ET-008
Mold Scraper	ET-009
Mold Brush	EB-R
Gas Torch	ET-010

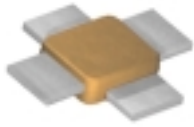

HBX



HBVB

BUS BAR SIZE (mm)	Mold	Weld Metal	Handle Clamp	Price Key
20X2	HBX202	#90	EC-M	M
20X2.5	HBX202.5	#90	EC-M	M
25X3	HBX253	#115	EC-M	M
30X2	HBX302	#90	EC-M	M
30X3.5	HBX303.5	#115	EC-M	M

For other sizes, contact EXOTECH distributor.

BUS BAR SIZE (mm)	Mold	Weld Metal	Handle Clamp	Price Key
20X2	HBVB202	#45	EC-M	M
20X3	HBVB203	#45		
20X5	HBVB205	#45		
25X2	HBVB252	#45	EC-M	H
25X3	HBVB253	#65		
25X4	HBVB254	#65		
25X5	HBVB255	#115		
30X2	HBVB302	#65	EC-M	H
30X3	HBVB303	#65		
30X4	HBVB304	#115		
30X5	HBVB305	#115		
40X3	HBVB403	#65	EC-M	H
40X4	HBVB404	#150		
40X5	HBVB405	#150		
40X6	HBVB406	#200		
50X3	HBVB503	#90	EC-M	H
50X4	HBVB504	#115	EC-M	H
50X5	HBVB505	#115	EC-M	H
50X6	HBVB506	#200	EC-M	H
50X8	HBVB508	#250	EC-M	H
50X10	HBVB5010	2X#150	EC-L	M+

For other sizes, contact EXOTECH distributor.

Place bars into position in the mold ensuring both run and tap bars are tightly seated in position.

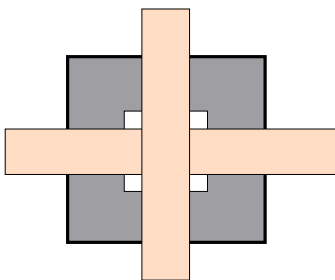

Place bars into position in the mold ensuring both run and tap bars are tightly seated in position. End of the tap bar must be even with top edge of the run bar.

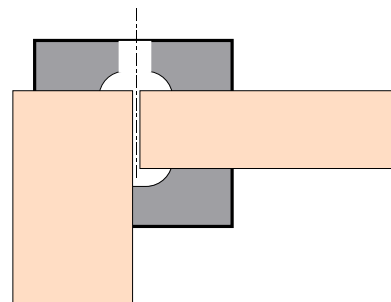

REQUIRED TOOLS	
Flint Ignitor	EF-R
SUGGESTED TOOLS	
Cable Cleaning Brush	ET-008
Mold Scraper	ET-009
Mold Brush	EB-R
Gas Torch	ET-010

REQUIRED TOOLS	
Flint Ignitor	EF-R
SUGGESTED TOOLS	
Cable Cleaning Brush	ET-008
Mold Scraper	ET-009
Mold Brush	EB-R
Gas Torch	ET-010

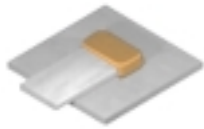

BHS



BVS

Tape (mm)	Mold	Weld Metal	Handle Clamp	Price Key
20X2	BHS202	#65	EC-M	M
20X3	BHS203	#90	EC-M	M
25X3	BHS253	#90	EC-M	M
25X5	BHS255	#115	EC-M	M
30X2	BHS302	#90	EC-M	H
30X3	BHS303	#115	EC-M	H
30X4	BHS304	#150	EC-M	H
30X5	BHS305	#200	EC-M	H
40X3	BHS403	#115	EC-M	H
40X4	BHS404	#200	EC-M	H
40X5	BHS405	#200	EC-M	H
40X6	BHS406	#250	EC-M	H
50X5	BHS505	2X#150	EC-L	M+
50X6	BHS506	2X#150	EC-L	M+
50X8	BHS508	2X#200	EC-L	M+

For other sizes, contact EXOTECH distributor.

Place bar into position in the mold ensuring the end of the bar is centered under the tap hole. Pressure must be applied on the closed mold cover to hold the mold in place.

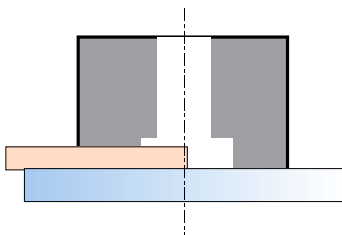

REQUIRED TOOLS	
Flint Ignitor	EF-R
SUGGESTED TOOLS	
Cable Cleaning Brush	ET-008
Mold Scraper	ET-009
Mold Brush	EB-R
Gas Torch	ET-010

Tape (mm)	Mold	Weld Metal	Handle Clamp	Price Key
20X2	BVS202	#65	EC-M	M
20X3	BVS203	#65	EC-M	M
25X3	BVS253	#90	EC-M	H
25X5	BVS255	#115	EC-M	H
30X2	BVS302	#90	EC-M	H
30X3	BVS303	#90	EC-M	H
30X4	BVS304	#115	EC-M	H
30X5	BVS305	#150	EC-M	H
40X3	BVS403	#150	EC-M	H
40X4	BVS404	#200	EC-M	H
40X5	BVS405	#200	EC-M	H
40X6	BVS406	#250	EC-M	H
50X5	BVS505	#250	EC-M	M+
50X6	BVS506	2X#150	EC-L	M+
50X8	BVS508	2X#200	EC-L	M+
60X6	BVS606	2X#200	EC-L	M+
60X8	BVS608	2X#250	EC-L	M+
60X10	BVS6010	3X#200	EC-L	M+
80X6	BVS806	2X#250	EC-L	M+
80X8	BVS808	3X#200	EC-L	M+
80X10	BVS8010	3X#250	EC-L	M+

For other sizes, contact EXOTECH distributor.

Place bar into position in the mold ensuring the bar is firmly seated against the steel surface. The use of a C clamp to hold the mold against the surface is recommended.

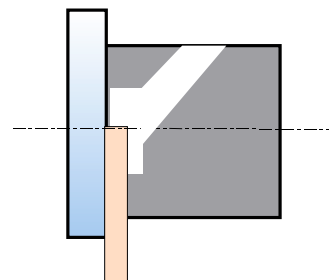

REQUIRED TOOLS	
Flint Ignitor	EF-R
SUGGESTED TOOLS	
Cable Cleaning Brush	ET-008
Mold Scraper	ET-009
Mold Brush	EB-R
Gas Torch	ET-010

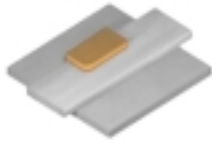

HBSS



BGRT

Tape (mm)	Mold	Weld Metal	Handle Clamp	Price Key
3X25 3X40 & WIDER	HBSS325 HBSS340	#115 #150	EC-M	H
5X25 5X40 & WIDER	HBSS525 HBSS540	#150 #200	EC-M	H
6X25 6X30 6X40 & WIDER	HBSS625 HBSS630 HBSS640	#150 #200 #250	EC-M	H
10X25 10X40 & WIDER	HBSS1025 HBSS1040	#200 #250	EC-M	H
12X25 12X40 & WIDER	HBSS1225 HBSS1240	#250 2X#150	EC-M	M+

For other sizes, contact EXOTECH distributor.

Place the bar into position in the mold ensuring the bar is tightly seated to both the steel plate and the edge of the bar. Pressure must be applied on the closed mold cover to hold the mold in place.

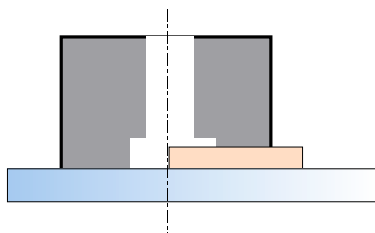

REQUIRED TOOLS	
Flint Ignitor	EF-R
SUGGESTED TOOLS	
Cable Cleaning Brush	ET-008
Mold Scraper	ET-009
Mold Brush	EB-R
Gas Torch	ET-010

Earth Rod Dia. (mm)	Tape (mm)	Mold	Weld Metal	Handle Clamp	Price Key
17.1	20X2	BGRT17-202	#150	EC-M	H
	20X3	BGRT17-203	#150		H
	25X3	BGRT17-253	#150		H
	25X5	BGRT17-255	#150		H
	30X3	BGRT17-303	#150		H
	30X5	BGRT17-305	#200	EC-M EC-L	H
	40X3	BGRT17-403	#200		H
	40X5	BGRT17-405	#200		H
	50X3	BGRT17-503	2X#150		M+
	50X5	BGRT17-505	2X#150		M+
	50X6	BGRT17-506	2X#150		M+
14.2	20X2	BGRT14-202	#90	EC-M	H
	20X3	BGRT14-203	#90		
	25X3	BGRT14-253	#115		
	25X5	BGRT14-255	#115		
	30X2	BGRT14-302	#115		
	30X4	BGRT14-304	#150		
	40X3	BGRT14-403	#150		
	40X5	BGRT14-405	#200		
	50X3	BGRT14-503	#200		
	50X5	BGRT14-505	#200		
	50X6	BGRT14-506	#250		
12.7	20X2	BGRT12-202	#90	EC-M	H
	20X3	BGRT12-203	#90		
	25X3	BGRT12-253	#115		
	25X5	BGRT12-255	#115		
	30X2	BGRT12-302	#115		
	30X4	BGRT12-304	#115		
	40X3	BGRT12-403	#115		
	40X5	BGRT12-405	#115		
	50X3	BGRT12-503	#200		
	50X5	BGRT12-505	#200		
	50X6	BGRT12-506	#200		

For other sizes, contact EXOTECH distributor.

Place the rod and bus bar into position in the mold. The bus bar should be positioned on top of the rod.

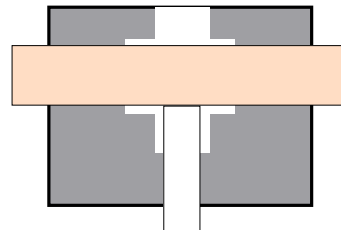

REQUIRED TOOLS	
Flint Ignitor	EF-R
SUGGESTED TOOLS	
Cable Cleaning Brush	ET-008
Mold Scraper	ET-009
Mold Brush	EB-R
Gas Torch	ET-010



BGRV



BGRC

Earth Rod Dia. (mm)	Tape (mm)	Mold	Weld Metal	Handle Clamp	Price Key
17.1	50X6	BGRV17506	2X#150	EC-L	M+
14.2	25X3	BGRV14253	#200	EC-M	H
12.7	25X3	BGRV12253	#150	EC-M	H
<i>For other sizes, contact EXOTECH distributor.</i>					

Earth Rod Dia. (mm)	Tape (mm)	Mold	Weld Metal	Handle Clamp	Price Key
25	25X3	BGRC25253	#150	EC-M	M+
19	25X3	BGRC19253	#150	EC-M	M+
17.1	25X6	BGRC17256	#200	EC-M	M+
	25X3	BGRC17253	#150		
14.2	25X3	BGRC14253	#150	EC-M	M+
<i>For other sizes, contact EXOTECH distributor.</i>					

Place the rod and bus bar into position in the mold. Ensure the bus bar is positioned on top of the rod.

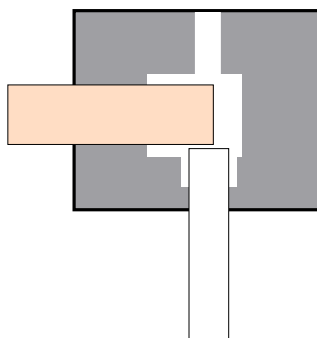

REQUIRED TOOLS	
Flint Ignitor	EF-R
SUGGESTED TOOLS	
Cable Cleaning Brush	ET-008
Mold Scraper	ET-009
Mold Brush	EB-R
Gas Torch	ET-010

Place the rod and bus bar into position in the mold. Ensure the mold is supported through the use of vice grip pliers or clamp via fixing to the mold.

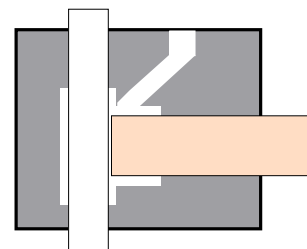

REQUIRED TOOLS	
Flint Ignitor	EF-R
SUGGESTED TOOLS	
Cable Cleaning Brush	ET-008
Mold Scraper	ET-009
Mold Brush	EB-R
Gas Torch	ET-010
Vice Grip Pliers	ET-007-1



HCHRZ



HCVRX

Rebar Size	Cable (mm ²)	Mold	Weld Metal	Handle Clamp	Price Key
12	25	HCHRZ1225	#45	EC-M	M
	35	HCHRZ1235	#45		M
	50	HCHRZ1250	#90		H
	70	HCHRZ1270	#90		H
	95	HCHRZ1295	#115		H
16	25	HCHRZ1625	#45	EC-M	H
	35	HCHRZ1635	#45		
	50	HCHRZ1650	#90		
	70	HCHRZ1670	#90		
	95	HCHRZ1695	#115		
18	35	HCHRZ1835	#45	EC-M	H
	50	HCHRZ1850	#90		
	70	HCHRZ1870	#90		
	95	HCHRZ1895	#115		
22	35	HCHRZ2235	#45	EC-M	H
	50	HCHRZ2250	#90		
	70	HCHRZ2270	#90		
	95	HCHRZ2295	#115		
25	35	HCHRZ2535	#45	EC-M	H
	50	HCHRZ2550	#90		
	70	HCHRZ2570	#90		
	95	HCHRZ2595	#115		
32	50	HCHRZ3250	#90	EC-M	H
	70	HCHRZ3270	#90		
	95	HCHRZ3295	#115		
36	50	HCHRZ3650	#90	EC-M	H
	70	HCHRZ3670	#90		
	95	HCHRZ3695	#115		

For other sizes, contact EXOTECH distributor.

Place the cable and rebar into position in the mold. The use of packing sealer is recommended.

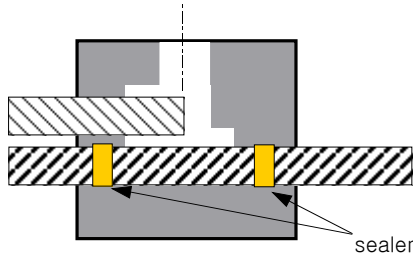

REQUIRED TOOLS

Flint Ignitor	EF-R
SUGGESTED TOOLS	
Cable Cleaning Brush	ET-008
Mold Scraper	ET-009
Mold Brush	EB-R
Gas Torch	ET-010
Packing Seal	ES-M

Rebar Size	Cable (mm ²)	Mold	Weld Metal	Handle Clamp	Price Key
12	25	HCVRX1225	#90	EC-M	M+
	35	HCVRX1235	#90		
	50	HCVRX1250	#115		
	70	HCVRX1270	#115		
	95	HCVRX1295	#150		
	120	HCVRX12120	#150		
16	25	HCVRX1625	#90	EC-M	M+
	35	HCVRX1635	#90		
	50	HCVRX1650	#115		
	70	HCVRX1670	#115		
	95	HCVRX1695	#150		
	120	HCVRX16120	#150		
18	25	HCVRX1825	#90	EC-M	M+
	35	HCVRX1835	#90		
	50	HCVRX1850	#115		
	70	HCVRX1870	#115		
	95	HCVRX1895	#150		
	120	HCVRX18120	#150		
22	25	HCVRX2225	#90	EC-M	M+
	35	HCVRX2235	#90		
	50	HCVRX2250	#115		
	70	HCVRX2270	#115		
	95	HCVRX2295	#150		
	120	HCVRX22120	#200		

For other sizes, contact EXOTECH distributor.

Place the cable and rebar into position in the mold. The use of packing sealer is recommended.

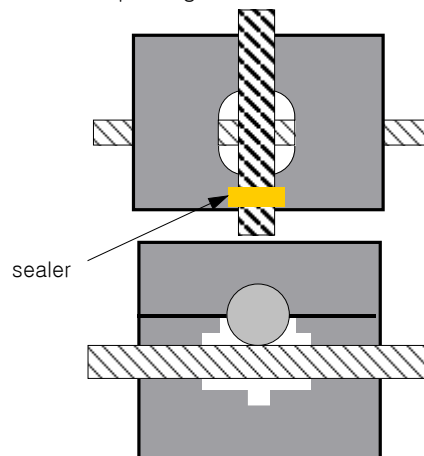

REQUIRED TOOLS

Flint Ignitor	EF-R
SUGGESTED TOOLS	
Cable Cleaning Brush	ET-008
Mold Scraper	ET-009
Mold Brush	EB-R
Gas Torch	ET-010
Packing Seal	ES-M



HCHRX



HCHRT

Rebar Size	Cable (mm ²)	Mold	Weld Metal	Handle Clamp	Price Key
13	25	HCHRX1325	#65	EC-M	M
	35	HCHRX1335	#90		M
	50	HCHRX1350	#115		H
	70	HCHRX1370	#115		H
	95	HCHRX1395	#150		H
16	25	HCHRX1625	#65	EC-M	M
	35	HCHRX1635	#90		M
	50	HCHRX1650	#115		H
	70	HCHRX1670	#115		H
	95	HCHRX1695	#150		H
18	35	HCHRX1835	#90	EC-M	J
	50	HCHRX1850	#115		
	70	HCHRX1870	#115		
	95	HCHRX1895	#150		
22	35	HCHRX2235	#90	EC-M	J
	50	HCHRX2250	#115		
	70	HCHRX2270	#115		
	95	HCHRX2295	#150		
25	35	HCHRX2535	#90	EC-M	J
	50	HCHRX2550	#115		
	70	HCHRX2570	#115		
	95	HCHRX2595	#150		
32	35	HCHRX3235	#90	EC-M	J
	50	HCHRX3250	#115		
	70	HCHRX3270	#115		
	95	HCHRX3295	#150		
36	35	HCHRX3635	#90	EC-M	J
	50	HCHRX3650	#115		
	70	HCHRX3670	#115		
	95	HCHRX3695	#150		

For other sizes, contact EXOTECH distributor.

Place the cable and rebar into position in the mold. The use of packing sealer is recommended.

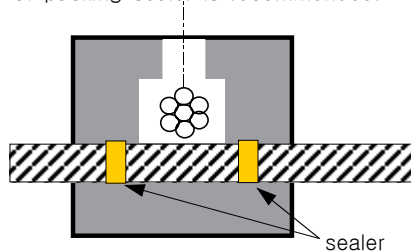

REQUIRED TOOLS	
Flint Ignitor	EF-R
SUGGESTED TOOLS	
Cable Cleaning Brush	ET-008
Mold Scraper	ET-009
Mold Brush	EB-R
Gas Torch	ET-010
Packing Seal	ES-M

Rebar Size	Cable (mm ²)	Mold	Weld Metal	Handle Clamp	Price Key
13	25	HCHRT1325	#65	EC-M	M
	35	HCHRT1335	#65		M
	50	HCHRT1350	#115		M
	70	HCHRT1370	#115		M
	95	HCHRT1395	#150		H
16	25	HCHRT1625	#65	EC-M	M
	35	HCHRT1635	#65		M
	50	HCHRT1650	#115		M
	70	HCHRT1670	#115		M
	95	HCHRT1695	#150		H
18	35	HCHRT1835	#65	EC-M	H
	50	HCHRT1850	#115		
	70	HCHRT1870	#115		
	95	HCHRT1895	#150		
22	35	HCHRT2235	#65	EC-M	H
	50	HCHRT2250	#115		
	70	HCHRT2270	#115		
	95	HCHRT2295	#150		
25	35	HCHRT2535	#65	EC-M	H
	50	HCHRT2550	#115		
	70	HCHRT2570	#115		
	95	HCHRT2595	#150		
32	35	HCHRT3235	#65	EC-M	H
	50	HCHRT3250	#115		
	70	HCHRT3270	#115		
	95	HCHRT3295	#150		
36	35	HCHRT3635	#65	EC-M	H
	50	HCHRT3650	#115		
	70	HCHRT3670	#115		
	95	HCHRT3695	#150		

For other sizes, contact EXOTECH distributor.

Place the cable and rebar into position in the mold. The use of packing sealer is recommended.

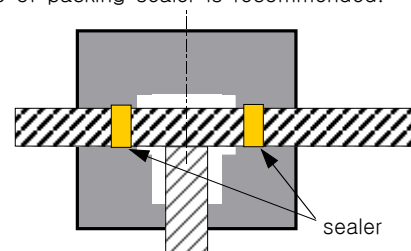

REQUIRED TOOLS	
Flint Ignitor	EF-R
SUGGESTED TOOLS	
Cable Cleaning Brush	ET-008
Mold Scraper	ET-009
Mold Brush	EB-R
Gas Torch	ET-010
Packing Seal	ES-M



HCVR



VCHRX

Rebar Size	Cable (mm ²)	Mold	Weld Metal	Handle Clamp	Price Key
13	25	HCVR1325	#65	EC-M	M+
	35	HCVR1335	#65		
	50	HCVR1350	#115		
	70	HCVR1370	#115		
	95	HCVR1395	#150		
16	25	HCVR1625	#65	EC-M	M+
	35	HCVR1635	#65		
	50	HCVR1650	#115		
	70	HCVR1670	#115		
	95	HCVR1695	#150		
18	35	HCVR1835	#65	EC-M	M+
	50	HCVR1850	#115		
	70	HCVR1870	#115		
	95	HCVR1895	#150		
	22	35	HCVR2235		
50		HCVR2250	#115		
70		HCVR2270	#115		
95		HCVR2295	#150		
25		35	HCVR2535	#65	EC-M
	50	HCVR2550	#115		
	70	HCVR2570	#115		
	95	HCVR2595	#150		
	32	35	HCVR3235	#65	
50		HCVR3250	#115		
70		HCVR3270	#115		
95		HCVR3295	#150		
36		35	HCVR3635	#65	EC-M
	50	HCVR3650	#115		
	70	HCVR3670	#115		
	95	HCVR3695	#150		

For other sizes, contact EXOTECH distributor.

Place the cable and rebar into position in the mold. Ensure the mold is supported through the use of vice grip pliers or a clamp via fixing to the rebar. The use of packing sealer is recommended.

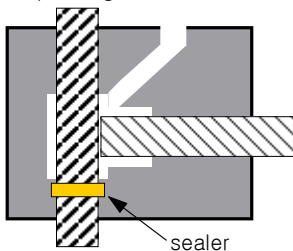

REQUIRED TOOLS

Flint Ignitor	EF-R
SUGGESTED TOOLS	
Cable Cleaning Brush	ET-008
Mold Scraper	ET-009
Mold Brush	EB-R
Gas Torch	ET-010
Vice Grip Pliers	ET-007-1
Packing Seal	ES-M

Rebar Size	Cable (mm ²)	Mold	Weld Metal	Handle Clamp	Price Key
10	10	VCHRX1010	#65	EC-M	M+
	16	VCHRX1016	#65		
	25	VCHRX1025	#90		
	35	VCHRX1035	#90		
	50	VCHRX1050	#115		
	70	VCHRX1070	#115		
	95	VCHRX1095	#150		
16	10	VCHRX1610	#65	EC-M	M+
	16	VCHRX1616	#65		
	25	VCHRX1625	#90		
	35	VCHRX1635	#90		
	50	VCHRX1650	#115		
	70	VCHRX1670	#115		
	95	VCHRX1695	#150		
20	10	VCHRX2010	#65	EC-M	M+
	16	VCHRX2016	#65		
	25	VCHRX2025	#90		
	35	VCHRX2035	#90		
	50	VCHRX2050	#115		
	70	VCHRX2070	#115		
	95	VCHRX2095	#150		
120	120	VCHRX20120	#150		

For other sizes, contact EXOTECH distributor.

Place the rebar and cable into position in the mold. Secure the back section of the mold into place ensuring the rebar is firmly in place. Ensure the mold is supported through the use of vice grip pliers or a clamp via fixing to the rebar. The use of packing sealer is recommended.

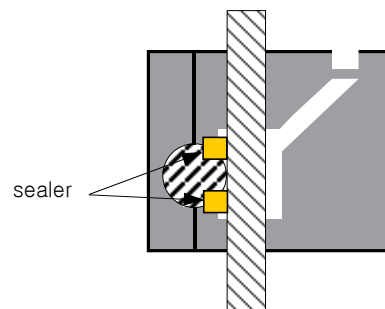

REQUIRED TOOLS

Flint Ignitor	EF-R
SUGGESTED TOOLS	
Cable Cleaning Brush	ET-008
Mold Scraper	ET-009
Mold Brush	EB-R
Gas Torch	ET-010
Vice Grip Pliers	ET-007-1
Packing Seal	ES-M



HCR



HCHR

Cable	Mold	Weld Metal	Handle Clamp	Price Key
3/16" Dia	HCR3/16L(R)	#25R	HCR-T	R
5/16" Dia	HCR5/16L(R)	#25R	HCR-T	R
38 sq	HCR38L(R)	#115R	HCR-T	R
60 sq	HCR60L(R)	#115R	HCR-T	R+
80 sq	HCR80L(R)	#150R	HCR-T	R+
100 sq	HCR100L(R)	#150R	HCR-T	R+
125 sq	HCR125L(R)	#200R	HCR-T	R+
150 sq	HCR150L(R)	#250R	HCR-T	R+
180 sq	HCR180L(R)	#250R	HCR-T	R+
200 sq	HCR200L(R)	#250R	HCR-T	R+
250 sq	HCR250L(R)	2X#150R	HCR-T	R+
400 sq	HCR400L(R)	2X#200R	HCR-T	R+
500 sq	HCR500L(R)	2X#200R	HCR-T	R+

For other sizes, contact EXOTECH distributor.

Cable	Mold	Weld Metal	Handle Clamp	Price Key
38 sq	HCHR38	#150R	HCR-T	R
60 sq	HCHR60	#150R	HCR-T	R+
80 sq	HCHR80	#200R	HCR-T	R+
100 sq	HCHR100	#200R	HCR-T	R+
125 sq	HCHR125	#250R	HCR-T	R+
150 sq	HCHR150	2X#150R	HCR-T	R+
180 sq	HCHR180	2X#150R	HCR-T	R+
200 sq	HCHR200	2X#150R	HCR-T	R+
250 sq	HCHR250	2X#200R	HCR-T	R+
400 sq	HCHR400	2X#250R	HCR-T	R+
500 sq	HCHR500	2X#250R	HCR-T	R+

For other sizes, contact EXOTECH distributor.

REQUIRED TOOLS	
Flint Ignitor	EF-R
SUGGESTED TOOLS	
Cable Cleaning Brush	ET-008
Mold Scraper	ET-009
Mold Brush	EB-R
Gas Torch	ET-010

REQUIRED TOOLS	
Flint Ignitor	EF-R
SUGGESTED TOOLS	
Cable Cleaning Brush	ET-008
Mold Scraper	ET-009
Mold Brush	EB-R
Gas Torch	ET-010















HRB

Cable	Mold	Weld Metal	Handle Clamp	Price Key
3/16" Dia	HRB 3/16	#25R	HRB-T	R1
5/16" Dia	HRB 5/16	#25R	HRB-T	R1
60 sq	HRB60	#65R	HRB-T	R2
100 sq	HRB100	#90R	HRB-T	R2
115 sq	HRB115	#115R	HRB-T	R2
125 sq	HRB125	#115R	HRB-T	R2
150 sq	HRB150	#150R	HRB-T	R2

For other sizes, contact EXOTECH distributor.

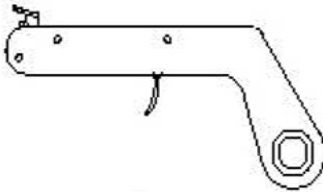
REQUIRED TOOLS	
Flint Ignitor	EF-R
SUGGESTED TOOLS	
Cable Cleaning Brush	ET-008
Mold Scraper	ET-009
Mold Brush	EB-R
Gas Torch	ET-010

Tool & Accessories for Track Circuit Application

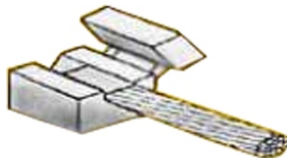
	HCR		HCR - T
	HCR		HCR Replacement Mold
	HRB		HRB - T
	HRB		KIT FOR RAIL CONTINUITY BONDS
	EFR		WELD METAL # 25gms (R)
	CONTINUITY BONDS 3/16- 6 1/2"		COPPER SLEEVE 3/16" (CS)
	CABLE 3/16		HAMMER DIE